

STUDY BY THE BAY

STUDY ABROAD WITH ENGLISH AT THE UNIVERSITY OF SOUTH FLORIDA





Welcome to the University of South Florida



A Top 50 Public US University

U.S. News & World Report 2021

ABOUT THE UNIVERSITY

The University of South Florida is **America's Fastest-Rising University**. The university ranks in the **Top 50** among public US universities (U.S. News and World Report 2020) and has a student body of over **50,000**. With **4,700+** international students from **141** countries, you will have the opportunity to make friends from all over the world. USF has the resources and prestige to be a leader in student success, ranking in the **Top 5** for student success among public research universities (Eduventures Student Success Ratings 2018).

USF is a **Pre-eminent Research University** that values ground breaking global research as a central part of the university's mission. The university is home to distinguished faculty members, **13** colleges and **11** state-of-the-art labs and research centers. USF is perfectly located in sunny Florida, which has been **#1 in Higher Education** for 3 years in a row (U.S. News and World Report 2019). Students will be able to study in the tropical city of Tampa, ranked **#2 Best Large College City** (WalletHub 2020).

Tier 1 Research University

Carnegie Classification of
Institutions of Higher Education

#3 Best Value Colleges in Florida

Niche 2021

USF at a glance



TAMPA CAMPUS

Founded: **1956**
Enrollment: **42,000+**
Bachelor's Master's/PhD Degrees: **200+**
Campus Size: **1,562 acres**
Student-to-Faculty Ratio: **21:1**

SARASOTA-MANATEE CAMPUS

Founded: **1975**
Enrollment: **2,000+**
Bachelor's Master's/PhD Degrees: **35+**
Campus Size: **2 acres**
Student-to-Faculty Ratio: **13:1**

ST. PETERSBURG CAMPUS

Founded: **1965**
Enrollment: **4,000+**
Bachelor's Master's/PhD Degrees: **79+**
Campus Size: **46 acres**
Student-to-Faculty Ratio: **19:1**



"I chose the Undergraduate Study Abroad with English program because I wanted to experience US student life and improve my English. I've already learned how to compose essays in Japanese, but in English it's a little bit different so it's really interesting to me. I'm also thinking to come back here for graduate school, so right now I'm working on it to make it happen."

Miki, Japan
Undergraduate Study Abroad with English

STUDY ABROAD WITH ENGLISH

Study Abroad with English (SAWE) combines Academic English courses with the chance to experience undergraduate and graduate courses and earn credits. This unique program allows students to earn college credits in their field of interest without having to enroll in a long-term degree program. The program can be customized for specific academic interests, with options in engineering, business, liberal arts and more.

Undergraduate

INTO USF offers a wider range of courses to undergraduate SAWE students, but currently can only include courses that are considered part of the Enhanced General Education here at USF. Students will work with an advisor to create their course schedules.

Key Program Facts

- Fall, Spring and Summer start dates
- Program length is 1-2 semesters; each semester is 4 months

Graduate

Graduate SAWE offers the opportunity to experience graduate-level courses at USF's MUMA College of Business. Students will work with an advisor to create their course schedules.

Key Program Facts

- Fall and Spring start dates
- Program length is 1-2 semesters; each semester is 4 months



STUDENT LIFE

Tampa Campus Activities and Amenities

- 700+ student organizations including international student clubs
- Weekly events such as movie nights, the Bull Market and multicultural events
- Competitive sports teams including soccer, football, baseball and cricket
- 3 Fitness Centers and USF Riverfront Park
- Over 30 different restaurants on campus
- On site bank, grocery store and pharmacy
- A free on campus bus service called the “Bull Runner”
- On campus art gallery, concerts and performances



Living in Tampa, Florida

- 1,000+ km of beaches
- 250 days of sunshine a year
- Average temperature of 28°C
- 1 hour drive from Disney World and Universal Studios
- Professional sports teams: The Buccaneers (Football), The Lightning (Hockey) and the Rays (Baseball)
- Top 20 most ethnically diverse Cities in The US (Niche 2020)
- Top 20 Safest Cities in Florida (National Council for Home Safety and Security 2019)

Downtown

USF Tampa campus is located just 30 minutes from our vibrant downtown. Students can discover the bustling night life of our historic Ybor City or take a stroll down our beautiful downtown Riverwalk. USF is 5 minutes away from Busch Gardens, Tampa’s very own theme park, and a 45 minute drive from St. Pete Beach, ranked America’s **#2 Beach** (TripAdvisor 2020).

Tampa, ranked **#16 most fun city in the US** (WalletHub 2019), is home to a thriving arts and cultural community. Students can visit museums, art festivals, live music events, the theatre and more. Tampa has a variety of luxury shopping and dining options, including Tampa Premium Outlets and Tampa’s International Plaza & Bay Market.



HOUSING AND DINING

Living on campus is the best way to get the full University of South Florida experience. USF offers four different types of housing and several dining options suited for every student’s needs. All students can live on campus, but priority is given to International Year One students. Learn about housing options at www.intostudy.com/usf/housing. For help with finding on-campus housing, please email INTOhousing@usf.edu



Apartment Style



Village Suite Style

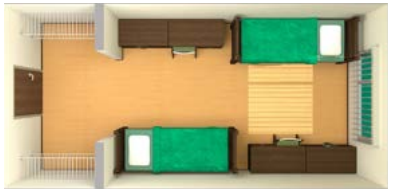

Village Traditional Style

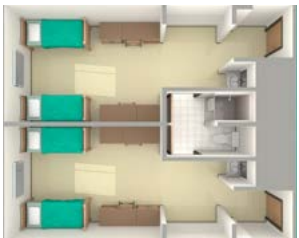

Suite Style

Housing Type	Cost
Suite style + All Access Meal Plan (Default housing)	\$8,300
Apartment Style + All Access Meal Plan	\$8,800
The Village Suite style + All Access Meal Plan	\$8,800
The Village Traditional style + All Access Meal Plan	\$7,700

* The length of housing required depends on your start date. **Note:** For students who decide to live off campus, the university has partnerships with a variety of apartment communities in the local area.

Features of Residence Hall Living

- Air conditioning
- Designated wheelchair-accessible rooms
- Kitchens on every floor
- Laundry facilities
- Study lounges
- Vending machines
- 24-hour, on-call emergency maintenance

Included in Your Room

Fully Furnished (Bed Frame and Mattress, Desk, Dresser, Chair, etc.)

All Access Meal Plan

Utilities (Water, Internet, Cable, Electricity)

Linen Pack



ENTRY REQUIREMENTS

Undergraduate				
SAWE One Semester	Program Components			Program notes
Entry Requirements <ul style="list-style-type: none">Open to recent high school graduates with High School Diploma and equivalent GPA of at least a 2.5 out of 4.0 or international students who have studied at college or university for at least one year and have maintained a 2.5+ GPAStatement of future plans and subjects of interestLanguage Requirement:<ul style="list-style-type: none">- TOEFL iBT 60-78- IELTS 5.5-6.0- PTEA 44-52- Completion of AE Level 4- Password Test Level 6- IELA 162- Duolingo 90	Semester 1	Course Title	Credit Hours	Because of the intense nature of Summer classes, students will be enrolled in fewer credit hours during the summer semester. Not all courses are available in the Summer. Math placement will be dictated by a placement test that is administered prior to arrival. These courses are generally delivered through the INTO USF Center.
	EAP 1850	English for International Students I	6	
	SLS 2505	Foundations of Interdisciplinary Knowledge and Inquiry	3	
	SPC 2608	Public Speaking	3	
	MAC 1105	College Algebra	3	
	Total		15	
	Courses shown are examples. See course list for options.			
SAWE Two Semesters	Program Components			
Entry Requirements <ul style="list-style-type: none">Open to recent high school graduates with High School Diploma and equivalent GPA of at least a 2.5 out of 4.0 or international students who have studied at college or university for at least one year and have maintained a 2.5+ GPAStatement of future plans and subjects of interestLanguage Requirement:<ul style="list-style-type: none">- TOEFL iBT 60-78- IELTS 5.5-6.0- PTEA 44-52- Completion of AE Level 4- Password Test Level 6- IELA 162- Duolingo 90	Semester 1	Course Title	Credit Hours	
	EAP 1850	English for International Students I	6	
	SLS 2505	Foundations of Interdisciplinary Knowledge and Inquiry	3	
	SPC 2608	Public Speaking	3	
	MAC 1105	College Algebra	3	
	Total		15	
	Courses shown are examples. See course list for options.			
	Semester 2	Course Title	Credit Hours	
	EAP 1851	English for International Students II	6	
	AMH 2020	American History II	3	
	EVR 2001	Environmental Science (or Physical Science)	3	
	PSY 2012	Introduction to Psychological Science	3	
	Total		15	
	Courses shown are examples. See course list for options.			
Study Abroad One Semester	Program Components			
Entry Requirements <ul style="list-style-type: none">Open to recent high school graduates with High School Diploma and equivalent GPA of at least a 2.5 out of 4.0 or international students who have studied at college or university for at least one year and have maintained a 2.5+ GPALanguage Requirement:<ul style="list-style-type: none">- TOEFL iBT 79+- IELTS 6.5+- PTEA 53+- IELA 176- Duolingo 105	Semester 1	Course Title	Credit Hours	
	SLS 2505	Foundations of Interdisciplinary Knowledge and Inquiry	3	
	SPC 2608	Public Speaking	3	
	ENC 1101	English Composition I	3	
	MAC 1105	College Algebra	3	
	PSY 2012	Introduction to Psychological Science	3	
	Total		15	
	Courses shown are examples. See course list for options.			

Graduate	
Program requirements	• 4-year undergraduate degree required with equivalent of a 2.5 GPA out of 4.0
Key Program Facts	• Fall and Spring start dates • Program length is 1-2 semesters; each semester is 4 month
TOEFL iBT	65+
IELTS	5.5+ (All subscores minimum 5.0)
Duolingo	95
Academic English	Level 5

Notes: Entry requirements are subject to change and may vary by program.
All international transcripts require an evaluation service. USF is competitive and meeting the minimum admission requirements does not guarantee admission.

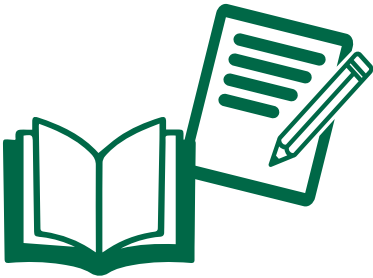

ACADEMIC ENGLISH

The Academic English program at USF prepares you for university study in the US. This innovative program offers content-based curriculum and provides students with intensive listening, speaking, reading and writing practice. You’ll receive high-quality English language instruction and the skills to succeed at USF.

What You Will Learn

- Experience and learn US academic culture.
- Present spoken and written ideas accurately and effectively in English.
- Write research papers with proper use of citations and references.
- Read, understand and critically evaluate academic texts.
- Understand and use vocabulary common to academic disciplines.
- Take useful and accurate notes in academic lectures and presentations.

Key Program Facts

Fall, Spring and Summer start dates (See page 11)
Each semester is 14 weeks (12 weeks in Summer)
Minimum enrollment of one semester
High school diploma required
No English language requirement; students will be assessed and placed upon arrival

Estimated Academic English (AE) Level Based on Test Scores

All students take a placement test during Orientation to determine their AE level. The table below shows your estimated level of AE based off your standardized test scores.

AE Levels		TOEFL iBT	IELTS	Duolingo
Level 1	Beginner	<30	<3.0	54
Level 2		30-40	3.0-3.5	55
Level 3		41-51	4.0-4.5	65
Level 4	Intermediate	52-59	5.0-5.5	75
Level 5		60-80	5.5-6.0	85
Level 6		>80	>6.0	95



“INTO USF offers many resources for you to improve your English. Especially because they have many subjects that you can study. For example, they offer speaking, listening, reading and writing classes. And also, you can choose an elective like a vocab classes or pronunciation.”

Lina, Colombia
Academic English



GRADUATE COURSE SELECTION

Graduate students can take courses with the MUMA College of Business. Graduate SAWE students will work in conjunction with an advisor to choose their courses.

UNDERGRADUATE COURSE SELECTION

Enhanced General Education Courses

The Enhanced General Education Program provides undergraduate students with an array of knowledge, skills, and experiences to prepare them to be successful citizens in life. The general education program provides students a rigorous academic context to develop intellectual and practical skills, personal and social responsibility, and application of learning through high impact practices. These courses might require pre-requisite courses or extra-fees and are subject to availability and offering. For the most up to date information please visit: www.usf.edu/intousf/programs/ugsawe.aspx

COLLEGE OF ARTS AND SCIENCES

Department of Anthropology

- ANT 2000 - Introduction to Anthropology Credit(s): 3
- ANT 2410 - Cultural Anthropology Credit(s): 3
- ANT 2511 - Biological Anthropology Credit(s): 3
- ANT 2511L - Biological Anthropology Laboratory Credit(s): 1

Department of Chemistry

- BSC 2010 - Cellular Processes Credit(s): 3
- BSC 2011 - Biodiversity Credit(s): 3
- CHM 2045 - General Chemistry I Credit(s): 3
- CHM 2046 - General Chemistry II Credit(s): 3
- PHY 2053 - General Physics I Credit(s): 3
- PHY 2054 - General Physics II Credit(s): 3

Department of Communication

- SPC 2608 - Public Speaking Credit(s): 3
- COM 2000 - Introduction to Communication Credit(s): 3

Department of Economics

- ECO 1000 - Basic Economics Credit(s): 3
- ECO 2013 - Economic Principles (Macroeconomics) Credit(s): 3
- ECO 2023 - Economic Principles (Microeconomics) Credit(s): 3
- ECO 2052 - Analytical Tools for Economists Credit(s): 3
- STA 2023 - Introductory Statistics I Credit(s): 3

Department of English

- ENC 1101 - Composition I Credit(s): 3
- ENC 1102 - Composition II Credit(s): 3
- LIT 2000 - Introduction to Literature Credit(s): 3
- SPC 2608 - Public Speaking Credit(s): 3
- ENC 2210 - Technical Writing Credit(s): 3

School of Geosciences

- EVR 2001 - Introduction to Environmental Science Credit(s): 3
- EVR 2001L - Environmental Science Lab Credit(s): 1
- EVR 2861 - Introduction to Environmental Policy Credit(s): 3
- GEO 2200 - Introduction to Physical Geography Credit(s): 3
- GEO 2400 - Human Geography Credit(s): 3

Department of History

- AMH 2010 - American History I Credit(s): 3
- AMH 2020 - American History II Credit(s): 3
- ASH 2270 - Southeast Asian History Credit(s): 3
- EUH 2011 - Ancient History I Credit(s): 3
- EUH 2012 - Ancient History II Credit(s): 3
- EUH 2021 - Byzantine Empire Credit(s): 3
- EUH 2022 - The Medieval West Credit(s): 3

COURSE SELECTION

Department of Mathematics and Statistics

- MAC 2311 - Calculus I Credit(s): 4
- MAC 2281 - Engineering Calculus I Credit(s): 4
- MAC 2312 - Calculus II Credit(s): 4
- MAC 2282 - Engineering Calculus II Credit(s): 4
- MAC 2313 - Calculus III Credit(s): 4
- MAC 2283 - Engineering Calculus III Credit(s): 4

Zimmerman School of Advertising and Mass Communications

- ADV 2214 - Graphic Programs in Mass Communications Credit(s): 3
- MMC 2100 - Writing for the Mass Media Credit(s): 3
- JOU 2100 - Beginning Reporting Credit(s): 3
- RTV 2100 - Writing For Radio and TV Credit(s): 3

MUMA COLLEGE OF BUSINESS

Business Analytics and Information Systems

Finance

Management

Marketing

- CGS 2100 - Computers in Business Credit(s): 3
- CGS 2100 - Computers in Business Credit(s): 3
- MAC 2233 - Business Calculus Credit(s): 3
- ECO 2013 - Economic Principles (Macroeconomics) Credit(s): 3
- ACG 2021 - Principles of Financial Accounting
- ACG 2071 - Principles of Managerial Accounting
- QMB 2100 - Business and Economic Statistics I

COLLEGE OF ENGINEERING

Courses apply to most Engineering programs

- EGN 3000 - Foundations of Engineering Credit(s): 0-3
- EGN 3000L - Foundations of Engineering Lab Credit(s): 3

COLLEGE OF PUBLIC HEALTH

Courses apply to most Public Health programs

- TGED - Human & Cultural Diversity Credit(s): 3
- HSC 2000 - Introduction to Health Professions Credit(s): 3
- BSC 2085 - Anatomy and Physiology I for Health Professionals Credit(s): 3
- BSC 2085L - Anatomy and Physiology Lab I for Nursing and other Healthcare Professionals Credit(s): 1
- SYG 2000 - Introduction to Sociology Credit(s): 3
- GEY 2000 - Introduction to Aging Sciences Credit(s): 3
- ANT 2511 - Biological Anthropology Credit(s): 3
- ANT 2410 - Cultural Anthropology Credit(s): 3
- COM 2130 - Communication Skills for Health Professionals Credit(s): 3
- DEP 2004 - The Life Cycle Credit(s): 3

COLLEGE OF THE ARTS

Art History

- ARH 2050 - History of Visual Arts I Credit(s): 3
- ARH 2051 - History of Visual Arts II Credit(s): 3
- ART 2201C - Concepts and Practices I Credit(s): 3
- ART 2301C - Beginning Drawing Credit(s): 3

Dance

- DAN 2160 - Entry Seminar Credit(s): 2
- DAA 2204 - Ballet I Credit(s): 2
- DAA 2104 - Modern Dance I Credit(s): 2

Music Composition

Music Performance

- MUT 1111 - Music Theory I Credit(s): 3
- MUT 1112 - Music Theory II Credit(s): 3
- MUT 2116 - Music Theory III Credit(s): 3
- MUE 2090 - Foundations of Music Education Credit(s): 3
- MUH 2020 - The History of Blues and Rock Credit(s): 3
- MUH 2051 - Folk and Traditional Music of World Cultures Credit(s): 3

Studio Art

- ARH 2050 - History of Visual Arts I Credit(s): 3
- ARH 2051 - History of Visual Arts II Credit(s): 3
- ART 2345 - Intermediate Drawing for Graphic Arts Credit(s): 3
- ART 2201C - Concepts and Practices I Credit(s): 3
- ART 2203C - Concepts and Practices II Credit(s): 3
- ART 2251 - Illustration I Credit(s): 3
- ART 2301C - Beginning Drawing Credit(s): 3
- ART 2400C - Beginning Printmaking Credit(s): 3
- ART 2500C - Beginning Painting Credit(s): 3



ABOUT THE INTO USF CENTER

THE INTO USF EXPERIENCE

Living and learning in the heart of the University of South Florida campus, students will develop friendships with American and international students and have access to all of the academic, social and cultural resources and activities at USF. Highly-qualified university instructors, facilities equipped with the latest technology, small classes, personalized support services, social activities, and a welcoming university community all contribute to the rich campus experience students will have at INTO USF.

AVAILABLE SERVICES

- Language and cultural support
- Free academic support and tutoring
- High level of personalized service
- Full-time Care and Conduct Coordinator
- Weekly student engagement events
- Academic advising
- Airport pick-up/concierge service
- Assistance with arrival, housing and dining



“INTO classes have a lot of speaking practice and I feel like I learn better when I speak than when I write. All the instructors remembered I was an international student and tried to help me a lot.”

Shohei, Japan
Study Abroad with English



DATES AND TUITION

SAWE DATES

Summer 2021	Fall 2021	Spring 2022	Summer 2022
May 11, 2021 - Aug 6, 2021	Aug 17, 2021 - Dec 9, 2021	Jan 4, 2022 - May 6, 2022	May 10, 2022 - Aug 5, 2022

ACADEMIC ENGLISH DATES

Summer 2021	Fall 2021	Spring 2022	Summer 2022
May 16, 2021 - Aug 6, 2021	Aug 29, 2021 - Dec 8, 2021	Jan 17, 2022 - May 5, 2022	May 15, 2022 - Aug 4, 2022

FEES

Expenses	Academic English	Study Abroad with English & Study Abroad Undergraduate	Study Abroad with English Graduate
Program Length	1 Semester	1 Semester	1 Semester
TUITION AND FEES	\$7,650	\$12,985	\$15,735
Housing and Meals	\$8,550	\$8,550	\$8,550
Books and Supplies	\$600	\$600	\$450
Insurance	\$1,190	\$1,190	\$1,190
Other*	\$1,625	\$1,625	\$1,625
LIVING EXPENSES**	\$11,965	\$11,965	\$11,815
TOTAL EXPENSES	\$19,615	\$24,950	\$27,550

*Other costs include transportation and miscellaneous personal expenses.

**Living expenses are estimates and will depend on housing options selected.

All prices are estimated from 2020-21 and are subject to change. Please visit: www.intostudy.com/usf/costs for exact pricing.

Discounts



INTO USF is now offering discounts to make your study abroad dreams a reality. The more you study the lower the cost. The discount will be applied to your total study plan.

2 Semesters of Study Abroad with English*

\$3,000 discount**

3 Semesters of Study Abroad with English*

\$4,000 discount**

*The above discounts apply to undergraduate programs.

**This amount represents a one time discount that will be applied to your total study plan.

APPLICATION PROCESS

Apply

Contact an education counselor for help with the application on the Partner Portal or apply online at:

www.intostudy.com/usf/apply

Send Required Documents

1. Copy of passport (and for spouse/dependents, if applicable)
2. Copy of bank statement and Affidavit of Support or letter of sponsorship
3. Copy of high school diploma (English and native language)
4. Copies of transcripts of all relevant qualifications translated into English as well as in native language
5. Copies of English language test scores

Application and Admissions Process

You will be notified by email as soon as your application is received. You will be informed if you will need to provide any missing application documents. Your transcripts and other documents must be evaluated and you will be contacted once an admission decision is made. If you have been accepted into the program, we will send you an offer of admission via email.

Confirm

Once qualified students have received their offer of admission, they will sign the acceptance form and pay the required deposit. INTO University of South Florida will then send them an I-20 to the shipping address provided.

Prepare for Arrival

You will receive a Welcome Guide to help prepare you for living and studying at USF.

Education counselor's stamp

HOW TO APPLY

Choose from two easy ways to apply

1 Apply via your local
INTO educational counselor

2 Apply online
Complete our online application form:
INTO USF Programs:
apply.intostudy.com/usf



INTO University of South Florida
For Pathway and English Programs

INTO University of South Florida
4202 East Fowler Avenue, FA0100
Tampa, FL 33620
USA

T: +1 813 905 4686

F: +1 813 905 9686

E: INTOadmissions@usf.edu

WhatsApp: +1 813 944 9488

www.intostudy.com/usf



facebook.com/intousf



twitter.com/into_usf



instagram.com/intousf



myin.to/USFYouTube



WeChat ID: **Uni_of_South_Florida**

Talk to Our Students!



WeChat



TAP

VIRTUAL CAMPUS TOUR Take a campus tour from home
with USF's Virtual Tour at www.youvisit.com/usf

Discover more online

For students:

www.intostudy.com/usf

For counselors:

partnerportal.intoglobal.com/usf