



QUEEN'S  
UNIVERSITY  
BELFAST

INTERNATIONAL  
STUDY CENTRE



# RUSSELL GROUP EXCELLENCE, UNBEATABLE VALUE

University pathways for  
international students  
**2025–26**



# A WORLD-CLASS EDUCATION, FOR LESS

Queen's University Belfast International Study Centre prepares you for study success at a Russell Group institution. For 175+ years, Queen's University Belfast has been shaping a better world through life-changing education and research. You'll be supported to maximise your potential, studying in an affordable, thriving city bursting with career opportunities.

**Give your future the best start. Choose Queen's.**



**Achieve more at an elite Russell Group university**  
Excellence in education since 1845 at the UK's 9th oldest university



**A world-class education for unbeatable value**  
Get more for your money with competitive tuition fees and guaranteed progression scholarships



**Enhance your employability in a growing tech city**  
Belfast is ranked in the top 10 fastest growing tech cities in the UK

(UK Digital Economy Council 2021)



## WHY CHOOSE QUEEN'S UNIVERSITY BELFAST INTERNATIONAL STUDY CENTRE?

**Get ready for a study abroad experience like no other.**

Our staff really care, going above and beyond to support you. We'll ensure your wellbeing, so you can focus on your studies – that's why our students go on to achieve great things.

With competitive tuition fees and generous scholarships, studying at Queen's International Study Centre makes financial sense too.

**98%**

overall student satisfaction  
(Annual Student Experience Survey 2024)

**97%**

of students graduate with a 2:2 or above\*

**Up to  
£14,500**

scholarships available for students who study at the centre and progress to Queen's University Belfast\*\*

"Your time with us is about ensuring you reach your full potential. We want you to progress to a top Russell Group university, whilst also equipping you with the skills to be successful at Queen's."

We're here to support your academic success and help you make the most of your time in this buzzing capital city."

**Liam O'Hagan**  
Centre Director, Queen's University Belfast International Study Centre



Watch Liam's welcome video



\* International Study Centre students who entered Year 1 of a 3-year degree, who graduated in 2022–23.

\*\* Visit our website for scholarship amounts, terms and conditions.



# ENABLING YOUR FUTURE CAREER

Brilliant leaders. Inspiring thinkers. Incredible pioneers. Queen’s high-achieving graduates have been shaping a better world since 1845.

Follow in their footsteps with the help of the Careers, Employability and Skills Team. Their services will help you develop the most in-demand skills that will unlock exciting career opportunities. How far will you go?



"I owe my academic and professional success to Queen’s. A combination of both hospital and community placements were provided each year. Under the supervision of qualified senior pharmacists, we were able to shadow their daily routine and partake in their practices. I felt fully prepared and confident when I graduated."

Ali, Kuwait  
Pharmacist at Jaber Al Ahmad Hospital  
• International Foundation  
• MPharm Pharmacy

Queen’s graduates have gone on to work for global companies, many of which are based in Belfast:

**1st** in the  
Russell Group  
for graduate  
employability\*

- |            |          |
|------------|----------|
| ACCENTURE  | KPMG     |
| AIRBUS UK  | PETRONAS |
| BOMBARDIER | PWC      |
| DELOITTE   | RANDOX   |
| GOOGLE     | UNILEVER |



## ENHANCING YOUR POTENTIAL

Your employability matters at Queen’s – a wide range of opportunities will help you develop future-ready skills.

You’ll benefit from:

- personalised careers guidance
- dedicated Careers Consultant within each School
- Future-Ready Award
- professionally accredited degrees
- placement and internship opportunities
- industry links with local, national and global companies
- free advice, incubation space and enterprise programmes for entrepreneurs
- MyFuture, an early career management platform and app
- Careers Fairs, employer panels and industry workshops.



## IT'S THE BEST DECISION I HAVE MADE IN MY LIFE.

"I wanted to study engineering at Queen’s because it’s a Russell Group university and it would be really good on my CV. After researching, I found that Queen’s engineering alumni went on to work at big companies like Aston Martin and Rolls Royce, where I ended up getting a placement. It’s the best decision I have made in my life."

Hassan, Pakistan  
Q & Accessories Engineer at Aston Martin Lagonda  
• International Year One  
• BEng (Hons) Mechanical Engineering

"My time spent at the centre really built my confidence and prepared me for university. The structure of my degree at Queen’s gave me the opportunity to study a placement year in Hong Kong. This is something that I think really made me stand out from other candidates when applying for jobs. I got a good job in London quickly after graduating."

Vicky, Hong Kong, China  
Actuarial Consultant at RNA Analytics Ltd  
• International Foundation  
• BSc (Hons) Actuarial Science

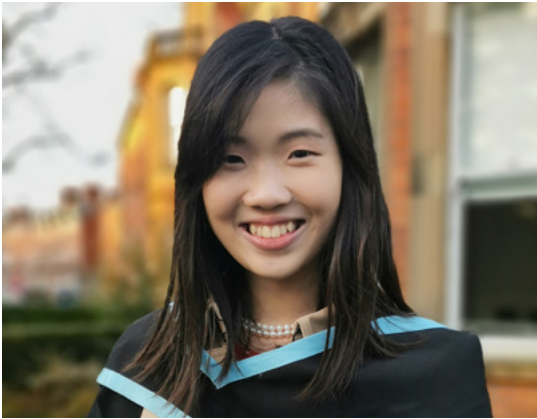

## 15 YEARS OF SUCCESS

The study centre and Queen’s University Belfast have provided world-class educational opportunities to international students for 15 years. Find out more about the achievements of the centre’s students during this time.



\* HESA Graduate Outcomes 2021/22



# STUDYING AT QUEEN'S

Stand out with a world-class Queen's education. You'll be taught by the best. Ground-breaking research informs degrees here, making your learning relevant. Highly ranked across many subject areas, you'll have a choice of over 200 degrees.

## BUSINESS MANAGEMENT AND FINANCE

Join the AMBA and EQUIS-accredited Queen's Business School.

- 3rd in the UK for Graduate Prospects in Accounting and Finance<sup>1</sup>.
- Accredited degrees, providing the first step towards chartered status.
- Placements and consulting projects at companies including Aviva, Citi, EY and KPMG.
- Masterclasses with international industry experts.
- Prizes and awards from leading finance companies for top-performing students.

### Facilities include:

- brand-new, state-of-the-art building with 250-seat tiered lecture theatre, 150-seat computer lab, interactive E-Learning suite and new FinTrU Trading Room with 26 Bloomberg terminals
- Queen's Student Managed Fund – a real-money investment portfolio
- software such as Matlab, RStudio and Stata, and databases including Bloomberg and Thomson One Banker.

## ENGINEERING AND TECHNOLOGY

Develop the skills you need to graduate into thriving engineering and tech industries.

- Huge range of specialisms, from aerospace to civil, and mechanical to computing and more.
- UK top 10 for Aeronautical and Aerospace Engineering<sup>2</sup>.
- The Russell Group's only combined School of Chemistry and Chemical Engineering.
- Industry placements at companies such as BP Chemicals, GSK, Jaguar Land Rover, Pfizer and Shell.

### Facilities include:

- £14 million Computer Science Building with cybersecurity suite and four Innovation Labs: Virtual Reality Lab, QLab Makerspace, Lego Smart City Lab and the Learning Lab
- Merlin Excalibur II flight simulator and flight test laboratory
- automotive test cells, catalyst laboratories and emissions analysers
- Baxter humanoid robot platform and 5-axis robot for robotic assembly.

## LIFE SCIENCES

Help work towards a healthier population, informed by cutting-edge research.

- Choose from degrees including Biomedical Science, Clinical Health Psychology, Food Science and Food Security, Midwifery Sciences, and Pharmacy.
- World =35 for Pharmacy and Pharmacology<sup>3</sup>.
- 3rd in the UK for Food Science<sup>1</sup>.
- World top 100 for Nursing<sup>3</sup>.
- Practical training for your future through placement opportunities with NGOs and in healthcare settings.

### Facilities include:

- specialist biomedical sciences and medical libraries
- Pharmacy Practice Unit with fully stocked dispensing workstations and industry-leading dispensing software
- microbiology, ecology, cell culture and parasitology labs
- state-of-the-art Simulation Centre providing simulated training for the next generation of healthcare professionals.

<sup>1</sup> The Times and The Sunday Times Good University Guide 2025

<sup>2</sup> The Complete University Guide 2025

<sup>3</sup> QS World University Rankings by Subject 2024

<sup>4</sup> Compared with average Russell Group fees (Reddin Survey 2021). Based on completion of BEng (Hons) Engineering with International Year One or International Year One plus 3 years of degree study, and securing centre and progression scholarships of £8,500.

## Save up to £42,500 – Russell Group's best value engineering education

Make your finances go further. Study an undergraduate degree with International Year One and you could save up to £42,500 over the course of your studies<sup>4</sup>. You'll graduate with an engineering or computer science degree in just three years, on a single visa. Accessible entry requirements mean you can study at a Russell Group university with confidence.

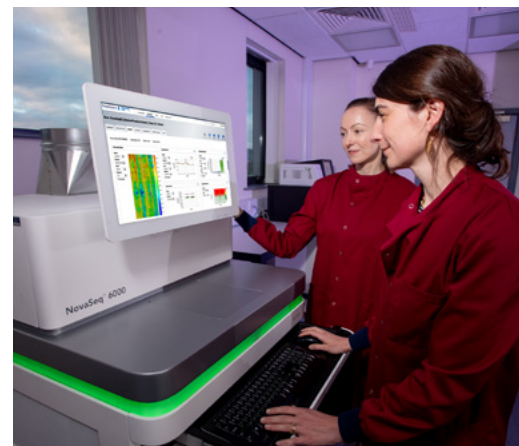
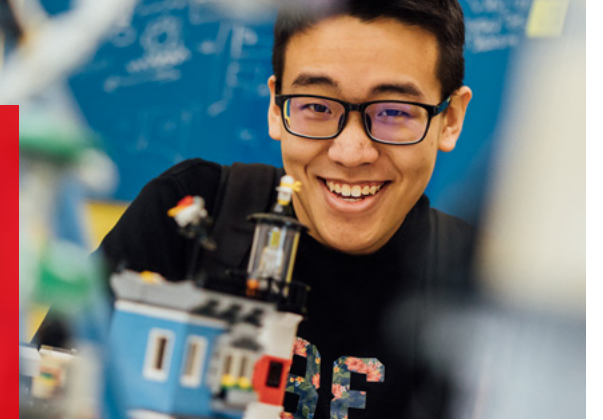

All students also have access to:

- the award-winning, technology-rich McClay Library
- Physical Education Centre featuring swimming pools, courts, cardio fitness area and climbing wall
- Students' Union with 200+ clubs and societies to join
- four chaplaincy centres on campus, each with a full-time chaplain.

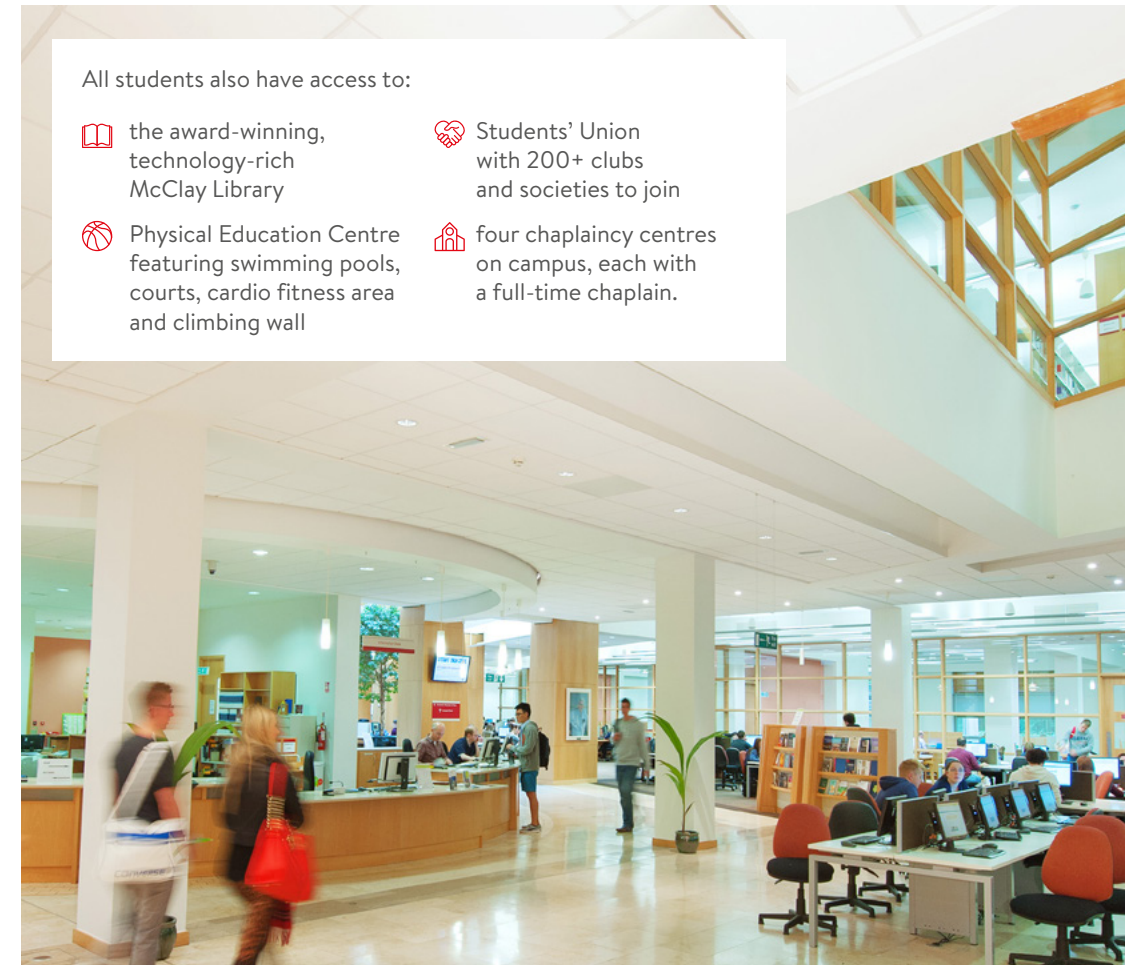

**99%**  
of Queen's  
research  
environment is  
world-leading or  
internationally  
excellent

(Research Excellence Framework 2021)





# LIFE ON CAMPUS

An inspiring location to learn. A stunning place to live. Queen's is one of the UK's top 10 most beautiful universities\*.

You'll find the study centre close to everything on campus, from the library to the Students' Union – so you'll be immersed in university life from day one.

## INVESTING IN YOUR STUDY EXPERIENCE

A £700 million investment in facilities is underway, developing the campus into an innovative learning environment.

There's a brand-new student centre – One Elmwood – on campus. This vibrant hub brings together the Students' Union and student services, so everything you need is in one place.

# 98%

of students agree that the centre made them feel welcome

(Annual Student Experience Survey 2024)

# 3RD BEST STUDENTS' UNION

in the UK

(Whatuni Student Choice Awards 2024)

## CENTRE FACILITIES

Modern classrooms with the latest technology.

Learning Resource Centre, with academic books, journals and workstations.

Lots of spaces for group work and quiet study.

Café Carberry, serving drinks and snacks with halal and vegetarian options.

Take a virtual tour of the campus:  
[virtualexperience.qub.ac.uk](https://virtualexperience.qub.ac.uk)

\* Times Higher Education 2023



## ALWAYS HERE TO SUPPORT YOU

A warm welcome from our friendly Student Services team awaits you.

Just some of the ways you'll be supported include:

- help opening a bank account and registering with a doctor
- workshops for help with renewing or extending your visa
- day trips, celebrations and an orientation programme
- a 24-hour emergency telephone number, just in case you need us
- one-to-one progression support, events and open days.

## QAA Reviewed

Quality Assurance Agency for Higher Education

"The inclusive academic and pastoral support provided enhances the quality of the student learning experience."

(QAA report 2023)



Recognised for:

- Excellence in teaching and learning resources
- Exceptional premises and resources

(British Council review 2023)



"I can't even express in words how welcomed I feel because they make me feel like I'm part of a family. Everyone cares about your wellbeing and that's really heart-warming."

Bisola, Nigeria  
Student Ambassador

International Foundation  
BSc (Hons) Biomedical Sciences





# YOUR HOME FROM HOME



**OVER £300  
PER MONTH  
CHEAPER FOR  
STUDENTS  
TO LIVE IN  
BELFAST  
COMPARED  
TO LONDON**

(Which? Student Budget  
Calculator 2022)

Take a tour of the  
accommodation



Living in university accommodation close to campus is a great opportunity to experience student life to the full. It's even better when you know you're staying somewhere safe, comfortable and affordable.

Which student residence will you choose?

## ELMS BT1, BT2 AND BT9

A private study bedroom with an ensuite bathroom.

Modern village-style residence with shared kitchen.

Communal lounge area with TV, games table and free of charge coffee bar.

Free off-peak Queen's Sport membership.

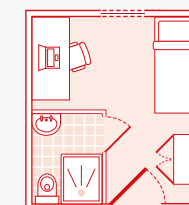

## WILLOW WALK

A private double room with a study space.

Shared bathroom and kitchen.

Communal lounge area with TVs and PCs.

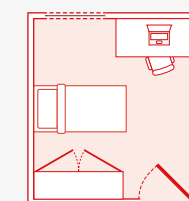

**!!  
THE ACCOMMODATION  
AT QUEEN'S IS EXCELLENT;  
YOU CAN LIVE QUIET AND  
PEACEFULLY OR GO OUT  
AND EXPLORE THE CITY!**

Vihan, Sri Lanka  
Consulting Analyst at Deloitte  
• International Year One  
• BEng (Hons) Electrical and Electronic Engineering

At all residences, you'll also benefit from:

- 10–20-minute walk to the study centre
- free Wi-Fi
- laundry facilities
- 24/7 security staff to keep you safe and supported
- extra support from Residential Assistants for students under 18
- guaranteed accommodation for your first year of study when you start your degree.





# WELCOME TO BELFAST

Friendly, fun, affordable. Belfast is the ideal student city. Northern Ireland's cosmopolitan capital may be compact, but it packs a lot in. Here you'll find a lively social life, a growing food scene, natural beauty and tons of history.

Safe and easy to explore, Belfast is a city that truly welcomes you.



ONE OF THE UK AND IRELAND'S MOST **VIBRANT** AND **AFFORDABLE** CITIES, PACKED WITH ENERGY, CULTURE AND HISTORY

(The Complete University Guide 2024)

## EXPERIENCE BELFAST

As the UK's most affordable student city\*, you'll have more money to spend on enjoying everything that Belfast has to offer, including:

- **Queen's Quarter** – Belfast's most vibrant district, with everything from cultural events and international festivals to world cuisine and vintage shops.
- **Cathedral Quarter** – bustling cobblestone streets home to live music, theatres, clubs, comedy and modern street art.
- **Botanic Gardens** – a beautiful city park, perfect for relaxing or studying outdoors.
- **Titanic Belfast museum** – the world's largest Titanic exhibition dedicated to the famous 'unsinkable' ship.

\* NatWest Student Living Index 2024



## GET MORE FOR YOUR MONEY IN BELFAST

	BELFAST	LONDON
Transport (single journey)	£2.35	£4.60
Eating out (inexpensive meal)	£16	£20
Weekly grocery shop	£40	£49
Cappuccino (regular)	£2.50**	£3.60
Cinema ticket	£9	£15
University accommodation	From £175	From £267†

Costs are estimates and are provided for illustrative purposes only. Sources include Numbeo.com 2024.

\*\* Price at the study centre café

† Based on weekly cost for a comparable Russell Group university in London



## EXPLORE NORTHERN IRELAND

Northern Ireland's scenery is legendary. There's nowhere else quite like it. Discover for yourself:

- the real **Winterfell** and other landmarks made famous by the HBO series **Game of Thrones**
- the dramatic **Giant's Causeway**, a **UNESCO World Heritage Site**, and stunning beaches – some just 25 minutes from Belfast
- the **Mourne Mountains**, an **Area of Outstanding Natural Beauty** and the inspiration for author CS Lewis' magical world of Narnia.

"Belfast is surrounded by beautiful natural landscape, so you can live in a city but also explore the countryside. I absolutely loved my trip to the Dark Hedges, which is a famous filming location for the HBO Series 'Game of Thrones'"

Xuanxin, China Mainland  
Pre-Master's



## WELL CONNECTED



**1**  
hour's flying  
time to all major  
UK cities

**2**  
airports  
in Belfast

**70+**  
direct flight  
destinations from  
Belfast to the  
UK, Europe and  
beyond

**2**  
hours by bus  
from Dublin's  
international  
airport

## LOWEST COST OF LIVING IN THE UK

(Mercer Cost of Living  
City Ranking 2023)



# A PLACE OF OPPORTUNITY

Business is booming in Belfast. The city has a growing tech scene and is a leading global location for investment projects. Along with the creation of 20,000 new jobs as part of the Belfast Region City Deal £1 billion+ investment, Belfast is a promising city for graduates.

And with the university playing a central role in driving innovation and growth, there's no better place to prepare for the jobs of the future.



“

## I GOT OFFERED A JOB 30 MINUTES AFTER GRADUATING!

"It was an exceptional learning experience to train me to become an accomplished aerospace engineer – I got offered a job 30 minutes after graduating!"

Dennise, Indonesia  
Design Engineer at Blow Moulding Technologies  
• International Foundation  
• BEng (Hons) Aerospace Engineering

Hear more  
from Dennise



”

## BELFAST IS A REALLY GOOD CITY TO BEGIN A CAREER IN BUSINESS.

"Belfast is a really good city to begin a career in business because a lot of the consulting firms are here, like Deloitte, Isio, PwC and EY."

Jesselyn, Indonesia  
• International Foundation  
• BSc (Hons) Actuarial Science and Risk Management

Hear more  
from Jesselyn



### GROWTH SECTORS

- Aerospace**  
1 in 3 aircraft seats are manufactured in Northern Ireland.
- Cyber security and AI**  
The world's top international investment location for US cyber security firms\*.
- Financial services**  
The world's top destination for Financial Services technology investment\*.
- Manufacturing and engineering**  
Grown more than four times faster than the rest of the UK\*\*.
- Software**  
UK top 10 fastest growing tech city†.

### CAREER CONNECTIONS

Take advantage of Queen's links with multinational companies, many of which are based in Belfast:

- |                     |                      |
|---------------------|----------------------|
| • ARUP              | • IBM                |
| • CITI              | • KPMG               |
| • DANSKE BANK       | • ORACLE             |
| • DELOITTE          | • PWC                |
| • EY                | • RANDOX             |
| • FIRST DERIVATIVES | • SPIRIT AEROSYSTEMS |

\* Financial Times fDi Markets 2021  
\*\* Invest Northern Ireland 2021  
† UK Digital Economy Council 2021



# CHOOSING YOUR COURSE

Prepare for your university degree with our academic courses, available in a range of subject pathways. Designed in partnership with Queen’s University Belfast, this is what your study journey could look like.



To find out more about each course, scan the QR code

## ACADEMIC COURSES

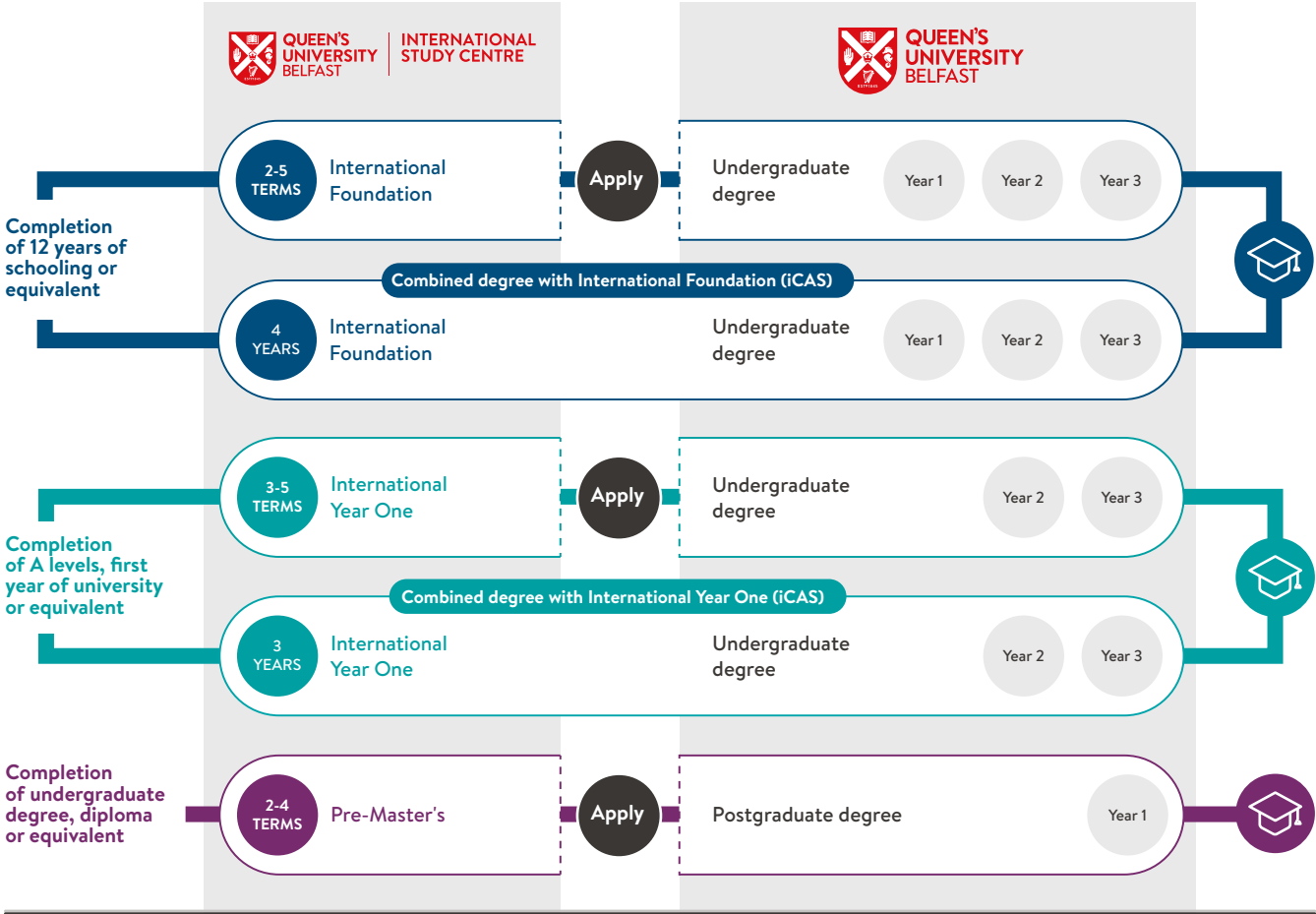

## ENGLISH LANGUAGE COURSES

Improve your English level fast with tailored, personalised support.

### Academic English

- An immersive course with small class sizes that will give you rapid progress of 0.5 to 1.0 IELTS point per term.
- More than language learning – develop the academic skills needed for successful UK study.
- Flexible start dates from January to October and study lengths from 1 to 4 terms to suit your individual needs.

### Pre-sessional English

- For Queen's University Belfast offer holders only.
- Improve your English language skills to the level required for your degree.
- 4, 6 or 10-week courses with start dates in June and July.
- Flexible online options available.

## Undergraduate Degree with Preparation Programme (iCAS)

Complete your Queen’s University Belfast undergraduate degree and your academic pathway in a single study plan and on one visa with our iCAS – integrated Confirmation of Acceptance for Studies (CAS) – programmes.

Depending on your academic qualifications and English language level, you can combine your degree studies with an International Foundation or International Year One. Choose from degrees in architecture, computer science, economics, finance and engineering-related subjects.

### WHY CHOOSE AN iCAS PROGRAMME?

- One visa for the whole length of your study plan.
- Apply with a range of English language qualifications – not just IELTS.
- No visa requirement to return home between your pathway and degree.
- Work up to 20 hours per week in the UK.

To find out more about iCAS programme options, scan the QR code



## YOU GET REAL EXPERIENCE IN THE FINANCIAL INDUSTRY.

"This degree makes you very competitive in the market compared with other candidates. You get real experience in the financial industry. It's a great opportunity to expand your network and help you get a job."

Keyu, China Mainland  
Expense/Revenue Analyst at Citi  
• International Year One  
• BSc (Hons) Finance with a Year in Industry



# INTERNATIONAL FOUNDATION

Improve your subject knowledge and English language skills to the level required to progress to Year 1 of an undergraduate degree at Queen’s University Belfast.

## ARCHITECTURE – IFPA

Choose from  
3 degrees.

Guarantee your place at a UK top 10\* architecture school. This programme leads to a fully accredited degree, giving you the opportunity to collaborate with leading architects on real-world projects and graduate as a qualified architect. A portfolio isn’t required as part of the application process.

### WHAT WILL I STUDY?

You’ll study all of these core modules:

English Language and Study Skills (30 credits)  
Practical Skills for Art Portfolio (30 credits)  
Principles of Architectural Design and Practice (30 credits)

Plus one of the following modules:

Foundation Mathematics (30 credits)  
Foundation Politics and International Relations (30 credits)

You’ll need to earn 120 credits from all module options.

## BUSINESS, HUMANITIES AND SOCIAL SCIENCES – IFPBHSS

Choose from  
35+ degrees.

Prepare for a degree in a range of accounting, economics, humanities, social sciences and law-related subjects. Interactive field trips, such as visits to the Law Courts and Northern Ireland Assembly in Belfast, will enhance your learning.

### WHAT WILL I STUDY?

You’ll study one core module:

English Language and Study Skills (30 credits)

Plus three of the following modules:

Foundation Business Studies (30 credits)  
Foundation Economics (30 credits)  
Foundation Mathematics (30 credits)  
Foundation Politics and International Relations (30 credits)  
Further Mathematics (30 credits)

You’ll need to earn 120 credits from all module options.

## SCIENCE AND ENGINEERING – IFPSE

Choose from  
100+ degrees.

Study one of two streams depending on your progression degree: Engineering and Physical Sciences, or Health and Life Sciences. Benefit from practical learning in the university’s fully equipped science labs.

### WHAT WILL I STUDY?

You’ll study all of these core modules:

English Language and Study Skills (30 credits)  
Foundation Mathematics for Engineering and Science (30 credits)

Plus two of the following modules:

Foundation Biology (30 credits)  
Foundation Chemistry (30 credits)  
Foundation Physics (30 credits)  
Further Mathematics (30 credits)

You’ll need to earn 120 credits from all module options.

\*The Times and The Sunday Times Good University Guide 2025

To find out more,  
scan the QR code



16 years and above



3-term: Sep or Jan  
4-term: Jun or Sep  
5-term: Jun or Mar



3-term: IELTS 5.0  
(with a minimum of 5.0 in writing and 4.5 in all other subskills) or equivalent.

4-term: IELTS 4.5  
(with a minimum of 4.5 in writing and 4.0 in all other subskills) or equivalent.

5-term: IELTS 4.0  
(with a minimum of 4.0 in all subskills) or equivalent



2-term: Apr  
3-term: Sep or Jan  
4-term: Jun or Sep  
5-term: Jun or Mar



2-term: IELTS 6.0  
(with a minimum of 5.5 in all subskills) or equivalent

3-term: IELTS 5.0  
(with a minimum of 5.0 in writing and 4.5 in all other subskills) or equivalent.

4-term: IELTS 4.5  
(with a minimum of 4.5 in writing and 4.0 in all other subskills) or equivalent.

5-term: IELTS 4.0  
(with a minimum of 4.0 in all subskills) or equivalent



2-term: Apr  
3-term: Sep or Jan  
4-term: Jun or Sep  
5-term: Jun or Mar



2-term: IELTS 6.0  
(with a minimum of 5.5 in all subskills) or equivalent.

3-term: IELTS 5.0  
(with a minimum of 5.0 in writing and 4.5 in all other subskills) or equivalent.

4-term: IELTS 4.5  
(with a minimum of 4.5 in writing and 4.0 in all other subskills) or equivalent.

5-term: IELTS 4.0  
(with a minimum of 4.0 in all subskills) or equivalent



Age requirement



Start dates



English requirements

Don’t meet the English requirements? Choose from a standalone Academic English course or combine English with an academic study plan to improve your IELTS score fast.

Once you’ve successfully completed your International Foundation programme, we’ll help choose your Queen’s University Belfast degree. Depending on your pathway, you could study one of 135+ degrees, including:

DEGREE	PATHWAY(S)	SPECIFIC REQUIREMENTS	ENGLISH LEVEL
Actuarial Science and Risk Management BSc (Hons)	IFPBHSS	AAA including Mathematics	Grade B with a minimum of Grade D in each component
Advanced Accounting with Placement MAcc	IFPBHSS	ABB + GCSE Mathematics grade B/6 or equivalent	Grade B with a minimum of Grade D in each component
Aerospace Engineering BEng (Hons)*	IFPSE	BBC including Mathematics and at least one from Physics(preferred), Biology, Chemistry or Further Mathematics + GCSE Physics Grade C or equivalent	Grade C with a minimum of Grade D in each component
Archaeology BA (Hons)	IFPBHSS	BBC	Grade B with a minimum of Grade D in each component
Architecture BSc (Hons)	IFPA	ABB + GCSE Mathematics Grade C or equivalent plus evidence of artistic ability (portfolio)	Grade B overall with a minimum of Grade C in Speaking and Listening and Grade D in Reading and Writing
Audio Engineering BSc (Hons)	IFPSE	BBB including Mathematics and at least one from Physics (preferred), Biology, Chemistry or Further Maths + GCSE Physics Grade C or equivalent	Grade B with a minimum of Grade D in each component
Biological Sciences BSc (Hons)	IFPSE	BBB including Biology and preferably Chemistry + GCSE Chemistry and Mathematics Grade C or equivalent	Grade B with a minimum of Grade D in each component
Biomedical Science BSc (Hons)	IFPSE	ABB including Biology or Chemistry (preferably both) + GCSE Biology, Chemistry and Mathematics Grade C or equivalent	Grade B with a minimum of Grade D in each component
Business Economics BSc (Hons)	IFPBHSS	BBB + GCSE Mathematics B/6 or equivalent	Grade B with a minimum of Grade D in each component
Business Management with Placement BSc (Hons)	IFPBHSS	BBB + GCSE Mathematics B/6 or equivalent	Grade B with a minimum of Grade D in each component
Chemical Engineering BEng (Hons)*	IFPSE	B (Mathematics) BC (including at least one from Biology, Chemistry or Physics) + GCSE Chemistry and Physics Grade C or equivalent	Grade C with a minimum of Grade D in each component
Chemistry BSc (Hons) BEng (Hons)	IFPSE	B (Chemistry) BC including a second Science subject + GCSE Mathematics grade C/4 or equivalent	Grade C with a minimum of Grade D in each component
Civil Engineering BEng (Hons)*	IFPSE	BBC (Mathematics and at least one from Biology, Chemistry or Physics) + GCSE Physics grade C or equivalent	Grade C with a minimum of Grade D in each component
Computer Engineering BEng (Hons)*	IFPSE	BBC (Mathematics and at least one from Physics (preferred), Biology, Chemistry or Further Mathematics)	Grade C with a minimum of Grade D in each component
Computer Science with Professional Experience BSc (Hons)*	IFPSE	BBC	Grade C with a minimum of Grade D in each component
Criminology BA (Hons)	IFPBHSS	BBB	Grade B with a minimum of Grade D in each component
Data Science with a Year of Professional Experience BSc (Hons)		A in Foundation Maths, BC including at least one from Physics, Biology, Chemistry, or Further Mathematics.	Grade C with a minimum of Grade D in each component
Drama BA (Hons)	IFPBHSS	BBC	Grade B with a minimum of Grade D in each component
Economics BSc (Hons)	IFPBHSS	BBB + GCSE Mathematics grade A/7 or equivalent	Grade B with a minimum of Grade D in each component
Electrical and Electronic Engineering BEng (Hons)*	IFPSE	BBC with B in Mathematics and at least one from Physics (preferred), Biology, Chemistry or Further Mathematics, and GCSE Physics grade 4/C or equivalent	Grade C with a minimum of Grade D in each component
Environmental Management BSc (Hons)	IFPSE	BBC including at least two from Biology, Economics and Geography + GCSE Mathematics grade C or equivalent	Grade B with a minimum of Grade D in each component
Film Studies and Production BA (Hons)	IFPBHSS	BBC	Grade B with a minimum of Grade D in each component
Finance with a Year in Industry BSc (Hons)	IFPBHSS	BBB including Mathematics	Grade B with a minimum of Grade D in each component
Food Science and Nutrition BSc (Hons)	IFPSE	BBB/BBC including Biology or Chemistry (preferably both) + GCSE Biology, Chemistry and Mathematics grade C/4 or equivalent	Grade B with a minimum of Grade D in each component
Geography BSc (Hons)	IFPA or IFPSE	BBC + GCSE Mathematics Grade C or equivalent	Grade B overall with a minimum of Grade D in all subskills
International Relations and Conflict Studies BA (Hons)	IFPBHSS	BBB	Grade B with a minimum of Grade D in each component
Law LLB (Hons)	IFPBHSS	AAB	Grade B with a minimum of Grade D in each component
Mechanical Engineering BEng (Hons)*	IFPSE	BBC with B in Mathematics and at least one from Physics (preferred), Biology, Chemistry or Further Mathematics, and GCSE Physics grade 4/C or equivalent	Grade C with a minimum of Grade D in each component
Medicinal Chemistry BSc (Hons)	IFPSE	B (Chemistry) BC including a second Science subject + GCSE Mathematics grade C/4 or equivalent	Grade C with a minimum of Grade D in each component
Microbiology BSc (Hons)	IFPSE	BBC including Biology and normally at least one from Chemistry (preferred), Mathematics or Physics and GCSE Mathematics grade C/4 or equivalent and GCSE Chemistry Grade B/6	Grade B with a minimum of Grade D in each component
Midwifery BSc (Hons)	IFPSE	CCC including Biology or Chemistry or Mathematics or Physics + 5 GCSE subjects at grade B/6 or equivalent, including Mathematics and a Science subject (Chemistry, Physics or Biology) plus successful interview	Grade A with a minimum of Grade A in Listening, Speaking and Reading and a minimum of Grade B in Writing
Music and Sound Design BA (Hons)	IFPBHSS	BBB	Grade B with a minimum of Grade D in each component
Music Performance BA (Hons)	IFPBHSS	BBB plus successful interview	Grade B with a minimum of Grade D in each component
Pharmaceutical Biotechnology BSc (Hons)	IFPSE	BBC including Biology and Chemistry	Grade B with a minimum of Grade C in each component
Pharmaceutical Sciences BSc (Hons)	IFPSE	BBC including Biology and Chemistry	Grade B with a minimum of Grade C in each component
Pharmacy MPharm (Hons)	IFPSE	AAB (Chemistry and one from Biology (preferred), Mathematics or Physics) + GCSE Biology and Mathematics grade C/4 or equivalent plus successful interview	Grade B with a minimum of Grade C in each component
Physics BSc (Hons)	IFPSE	BB (Mathematics and Physics) C	Grade C with a minimum of Grade D in each component
Planning, Environment & Development BSc (Hons)	IFPA or IFPSE	BBC + GCSE Mathematics Grade C or equivalent	Grade B overall with a minimum of Grade D in all subskills
Politics, Philosophy and Economics BA (Hons)	IFPBHSS	ABB + GCSE Mathematics grade B/6 or equivalent	Grade B with a minimum of Grade D in each component
Psychology BSc (Hons)	IFPSE	BBB + GCSE Mathematics grade B/6 or equivalent	Grade B with a minimum of Grade D in each component
Sociology BA (Hons)	IFPBHSS	BBC	Grade B with a minimum of Grade D in each component
Software Engineering with Placement BEng (Hons)*	IFPSE	BBC including Mathematics or BBC including Physics or Chemistry and + GCSE Mathematics grade C or equivalent	Grade C with a minimum of Grade D in each component

\* Master’s option available.

Degree option with a work placement also available



# UNDERGRADUATE DEGREE WITH INTERNATIONAL FOUNDATION (iCAS)

Complete your International Foundation and undergraduate degree on a single visa, with no need to renew for the duration of your studies.

## BSC (HONS) ARCHITECTURE WITH INTERNATIONAL FOUNDATION

Work towards graduating with a professionally accredited degree. Ranking 10th in the UK for Architecture\*, Queen's offers a strong studio culture with the opportunity to learn from peers and practicing architects. A portfolio isn't required as part of the application process.

### WHAT WILL I STUDY?

#### You'll study all of these core modules:

English Language and Study Skills (30 credits)  
Practical Skills for Art Portfolio (30 credits)  
Principles of Architectural Design and Practice (30 credits)

#### Plus one of the following modules:

Foundation Politics and International Relations (30 credits)  
Foundation Mathematics (30 credits)

You'll need to earn 120 credits from all module options to successfully complete Year 1 of your study plan.

## BENG (HONS) CIVIL ENGINEERING WITH INTERNATIONAL FOUNDATION

One of the founding degrees at Queen's, today civil engineering here is in the world top 200\*\*. Learn about the planning, design and construction of infrastructure, with the chance to tailor your accredited degree to your skills and interests. Year in industry option also available.

### WHAT WILL I STUDY?

#### You'll study all of these core modules:

English Language and Study Skills (30 credits)  
Foundation Mathematics (30 credits)

#### Plus two of the following modules:

Foundation Physics (30 credits)  
Foundation Chemistry (30 credits)  
Foundation Biology (30 CATS)  
Further Mathematics (30 CATS)

You'll need to earn 120 credits from all module options to successfully complete Year 1 of your study plan.

## BSC (HONS) COMPUTER SCIENCE PROFESSIONAL EXPERIENCE WITH INTERNATIONAL FOUNDATION

Study an industry-led degree, designed to prepare you for your future career. Benefit from links with 500+ global employers – including IBM, Fujitsu, IBM and Siemens – offering valuable work experience, teaching and scholarships.

### WHAT WILL I STUDY?

#### You'll study all of these core modules:

English Language and Study Skills (30 credits)  
Foundation Mathematics (30 credits)

#### Plus two of the following modules:

Foundation Physics (30 credits)  
Foundation Chemistry (30 credits)  
Foundation Biology (30 CATS)  
Further Mathematics (30 CATS)

You'll need to earn 120 credits from all module options to successfully complete Year 1 of your study plan.

\* The Times and The Sunday Times Good University Guide 2025  
\*\* QS World University Rankings by Subject 2024

# INTERNATIONAL YEAR ONE

Don't meet the English requirements? Choose from a standalone Academic English course or combine English with an academic study plan to improve your IELTS score fast.

Improve your subject knowledge and English language skills to the level required to progress to Year 2 of an undergraduate degree at Queen's University Belfast.

## ACCOUNTING – IYOA

Choose from 2 degrees.

Develop the skills you need to join the globally renowned Queen's Business School. Learn how to use specialist accounting software and gain experience analysing statistics and writing detailed financial reports.

### WHAT WILL I STUDY?

#### You'll study all of these core modules:

Accounting Information Systems (10 credits)  
English Language and Study Skills (20 credits)  
Introduction to Financial Accounting (20 credits)  
Introduction to Legal Studies and Basic Contract Law (20 credits)

Introduction to Management Accounting (20 credits)  
Principles of Economics (20 credits)  
Statistical Methods for Business (10 credits)

You'll need to earn 120 credits from all module options.

## ENGINEERING – IYOE

Choose from 35 degrees.

Choose from six specialist sub-pathways, leading to a degree at a university ranked in the world top 175 for Engineering\*. Learn from PhD level subject lecturers while gaining hands-on experience through laboratory work.

### WHAT WILL I STUDY?

#### You'll study all of these core modules:

Engineering Mathematics 1 (10 credits)  
Engineering Mathematics 2 (10 credits)  
English Language and Study Skills (20 credits)

#### Plus eight specialist modules for:

Aerospace Engineering, Chemical Engineering, Civil Engineering, Electrical and Electronic Engineering, Computer Science and Mechanical Engineering

You'll need to earn 120 credits from all module options.

## MANAGEMENT AND FINANCE – IYOMF

Choose from 5 degrees.

Secure your place on an accredited or professionally recognised finance-related degree. Learn to analyse case studies and discuss current economic affairs as well as develop key skills in business reporting.

### WHAT WILL I STUDY?

#### You'll study all of these core modules:

English Language and Study Skills (20 credits)  
Introduction to Financial Management and Accounting (20 credits)  
Principles of Economics (20 credits)  
Statistical Methods for Business (10 credits)

#### Plus a choice of specialist modules:

Financial Institute and Markets (20 credits)  
Management and Organisation: Theory and Practice (20 credits)  
Marketing (10 credits)  
Mathematics for Finance (20 credits)  
Price Theory (10 credits)  
The Business Environment (20 credits)

You'll need to earn 120 credits from all module options.

To find out more, scan the QR code



\* Times Higher Education World University Rankings by Subject 2024



16 years and above



Year 1 of study plan  
4 years: Sep or Jan



4 years: IELTS 5.5 (with a minimum of 5.5 in all subskills) or equivalent.

Please note that in addition to the UKVI IELTS, we are able to accept other English language qualifications. For more information on accepted qualifications please see: [intostudy.com/self-alternatives](https://intostudy.com/self-alternatives)



Year 1 of study plan  
4 years: Sep or Jan



4 or 5 years\*: IELTS 5.5 (with a minimum of 5.5 in all subskills) or equivalent.

Please note that in addition to the UKVI IELTS, we are able to accept other English language qualifications. For more information on accepted qualifications please see: [intostudy.com/self-alternatives](https://intostudy.com/self-alternatives)

\* Optional placement year



Year 1 of study plan  
5 years: Sep or Jan



5 years: IELTS 5.5 (with a minimum of 5.5 in all subskills) or equivalent.

Please note that in addition to the UKVI IELTS, we are able to accept other English language qualifications. For more information on accepted qualifications please see: [intostudy.com/self-alternatives](https://intostudy.com/self-alternatives)



Age requirement



Start dates



English requirements



16 years and above



3-term: Sep or Jan  
4-term: Jun or Sep  
5-term: Jun or Mar



3-term: IELTS 5.5 (with a minimum of 5.5 in reading and writing and 5.0 in all other subskills) or equivalent.

4-term: IELTS 5.0 (with a minimum of 5.0 in reading and writing and 4.5 in all other subskills) or equivalent.

5-term: IELTS 4.5 (with a minimum of 4.5 in all other subskills) or equivalent.



3-term: Sep or Jan  
4-term: Jun or Sep  
5-term: Jun or Mar



3-term: IELTS 5.5 (with a minimum of 5.5 in reading and writing and 5.0 in all other subskills) or equivalent.

4-term: IELTS 5.0 (with a minimum of 5.0 in reading and writing and 4.5 in all other subskills) or equivalent.

5-term: IELTS 4.5 (with a minimum of 4.5 in all other subskills) or equivalent.



3-term: Sep or Jan  
4-term: Jun or Sep  
5-term: Jun or Mar



3-term: IELTS 5.5 (with a minimum of 5.5 in reading and writing and 5.0 in all other subskills) or equivalent.

4-term: IELTS 5.0 (with a minimum of 5.0 in reading and writing and 4.5 in all other subskills) or equivalent.

5-term: IELTS 4.5 (with a minimum of 4.5 in all other subskills) or equivalent.



Age requirement



Start dates















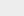

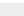
English requirements

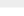

# INTERNATIONAL YEAR ONE

Once you’ve successfully completed your International Year One programme, we’ll help choose your Queen’s University Belfast degree. Depending on your pathway, you could study one of 40+ degrees, including:

DEGREE	PATHWAY(S)	SPECIFIC REQUIREMENTS	ENGLISH LEVEL
Advanced Accounting with Placement MAcc	IYOA	50% overall average in academic modules. A minimum of 50% in Mathematics for Statistics and Business, Introduction to Financial Accounting, Introduction to Management Accounting, and Introduction to Legal Study and Basic Contract Law	Grade B with a minimum of Grade D in each component
Aerospace Engineering BEng (Hons) <sup>†</sup> 	IYOE	A pass with Commendation with a minimum average of 60% and passes in all 10 modules	Grade C with a minimum of grade D in each component
Aerospace Engineering MEng (Hons) 	IYOE	A pass with High Commendation with a minimum average of 70% and passes in all 10 modules	Grade C with a minimum of grade D in each component
Business Economics BSc (Hons)	IYOMF	50% overall average in academic modules. A minimum of 50% in Management and Organisation: Theory and Practice, Principles of Economics, and The Business Environment, and passes in all other modules	Grade B with a minimum of grade D in each component
Business Management BSc (Hons) 	IYOMF	50% overall average in academic modules. A minimum of 50% in Management and Organisation: Theory and Practice, Principles of Economics, and The Business Environment, and passes in all other modules	Grade B with a minimum of grade D in each component
Chemical Engineering BEng (Hons) <sup>†</sup> 	IYOE	A pass with Commendation with a minimum average of 60% and passes in all 10 modules	Grade C with a minimum of grade D in each component
Chemical Engineering MEng (Hons) 	IYOE	A pass with High Commendation with a minimum average of 70% and passes in all 10 modules	Grade C with a minimum of grade D in each component
Civil Engineering BEng (Hons) <sup>†</sup> 	IYOE	A pass with Commendation with a minimum average of 60% and passes in all 10 modules	Grade C with a minimum of grade D in each component
Civil Engineering MEng (Hons) 	IYOE	A pass with High Commendation with a minimum average of 70% and passes in all 10 modules	Grade C with a minimum of grade D in each component
Computer Engineering BEng (Hons)	IYOE	A pass with Commendation with a minimum average of 60% and passes in all 10 modules	Grade C with a minimum of grade D in each component
Computer Engineering MEng (Hons) 	IYOE	A pass with High Commendation with a minimum average of 70% and passes in all 10 modules	Grade C with a minimum of grade D in each component
Computer Science BSc (Hons) <sup>†</sup> 	IYOE	A pass with Commendation with a minimum average of 60% and passes in all 10 modules	Grade C with a minimum of grade D in each component
Computer Science MEng (Hons) 	IYOE	A pass with High Commendation with a minimum average of 70% and passes in all 10 modules	Grade C with a minimum of grade D in each component
Computing and Information Technology including Professional Experience BSc (Hons)	IYOE	A pass with Commendation with a minimum average of 60% and passes in all 10 modules	Grade C with a minimum of grade D in each component
Economics and Accounting BSc (Hons)	IYOA	50% overall average in academic modules. A minimum of 50% in Mathematics for Statistics and Business, Introduction to Financial Accounting, Introduction to Management Accounting, and Introduction to Legal Study and Basic Contract Law	Grade B with a minimum of Grade D in each component
Economics BSc (Hons)	IYOMF	50% overall average in academic modules. A minimum of 50% in Principles of Economics; Financial Institutions and Markets; and Mathematics for Finance and Economics, and passes in all other modules	Grade B with a minimum of grade D in each component
Economics with Finance BSc (Hons)	IYOMF	50% overall average in academic modules. A minimum of 50% in Principles of Economics; Financial Institutions and Markets; and Mathematics for Finance and Economics, and passes in all other modules	Grade B with a minimum of grade D in each component
Electrical and Electronic Engineering BEng (Hons) <sup>†</sup> 	IYOE	A pass with Commendation with a minimum average of 60% and passes in all 10 modules	Grade C with a minimum of grade D in each component
Electrical and Electronic Engineering MEng (Hons) 	IYOE	A pass with High Commendation with a minimum average of 70% and passes in all 10 modules	Grade C with a minimum of grade D in each component
Environmental and Civil Engineering MEng (Hons)	IYOE	A pass with High Commendation with a minimum average of 70% and passes in all 10 modules	Grade C with a minimum of grade D in each component
Finance BSc (Hons) 	IYOMF	50% overall average in academic modules. A minimum of 55% in Financial Institutions and Markets, 50% in Principles of Economics and Mathematics for Finance and Economics, and passes in all other modules.	Grade B with a minimum of grade D in each component
Mechanical Engineering BEng (Hons) <sup>†</sup> 	IYOE	A pass with Commendation with a minimum average of 60% and passes in all 10 modules	Grade C with a minimum of grade D in each component
Mechanical Engineering MEng (Hons) 	IYOE	A pass with High Commendation with a minimum average of 70% and passes in all 10 modules	Grade C with a minimum of grade D in each component
Software Engineering BEng (Hons) 	IYOE	A pass with Commendation with a minimum average of 60% and passes in all 10 modules	Grade C with a minimum of grade D in each component
Software Engineering MEng (Hons) 	IYOE	A pass with High Commendation with a minimum average of 70% and passes in all 10 modules	Grade C with a minimum of grade D in each component
Structural Engineering with Architecture MEng (Hons)	IYOE	A pass with High Commendation with a minimum average of 70% and passes in all 10 modules	Grade C with a minimum of grade D in each component

 Degree option with a work placement also available

<sup>†</sup> Undergraduate Degree with International Year One is also available.  
Please note: English level and academic progression requirements are correct to the best of our knowledge at the time of going to print. In some circumstances these may change throughout the year – please visit our website for the most up-to-date information.

To find out more,  
scan the QR code



# UNDERGRADUATE DEGREE WITH INTERNATIONAL YEAR ONE (iCAS)

Complete your International Year One and undergraduate degree on a single visa, with no need to renew for the duration of your studies.

## ACCOUNTING, BUSINESS AND FINANCE

Work towards graduating from the AMBA and EQUIS-accredited Queen’s Business School – ranked 8th in the UK for Graduate Prospects in Economics\*. You’ll benefit from a dedicated Careers and Work Placement team, which has established strong links with business partners providing internships and consulting projects.

### WHAT WILL I STUDY?

The table below provides information about the core and specialist modules you’ll need to study based on the degree option chosen. You’ll need to earn 120 credits from all module options to successfully complete Year 1 of your study plan and continue to Year 2 of your degree at Queen’s University Belfast.

All specialist modules are taught by academic experts in these subject areas.

DEGREE								
CORE AND SPECIALIST MODULES		Advanced Accounting (with Placement) MAcc	Business Economics BSc (Hons)	Business Management (with Placement) BSc (Hons)	Economics and Accounting BSc (Hons)	Economics BSc (Hons)	Economics with Finance BSc (Hons)	Finance (with a Year in Industry) BSc (Hons)
	Accounting Information Systems	●			●			
	The Business Environment		●	●				
	English Language and Study Skills	●	●	●	●	●	●	●
	Financial Institutions and Markets					●	●	●
	Introduction to Financial Accounting	●			●			
	Introduction to Financial Management and Accounting		●	●		●	●	●
	Introduction to Legal Studies and Basic Contract Law	●			●			
	Introduction to Management Accounting	●			●			
	Marketing		●	●				
	Management and Organization: Theory and Practice		●	●				
	Mathematics for Finance					●	●	●
	Price Theory					●	●	●
	Principles of Economics	●	●	●	●	●	●	●
	Statistical Methods for Business	●	●	●	●	●	●	●

For full module descriptions, please refer to the programme pages on our website.

\* The Times and The Sunday Times Good University Guide 2025

 16 years and above

 Year 1 of study plan  
3-term: Sep or Jan

 3-term: IELTS 5.5 (with a minimum of 5.5 in each subskill) or equivalent.

Please note that in addition to the UKVI IELTS, we can accept other English language qualifications. For more information on accepted qualifications please see: [intostudy.com/selt-alternatives](https://intostudy.com/selt-alternatives)



# UNDERGRADUATE DEGREE WITH INTERNATIONAL YEAR ONE (iCAS)

Complete your International Year One and undergraduate degree on a single visa, with no need to renew for the duration of your studies.

## ENGINEERING

Join the 96% of study centre students who graduate with a 2:2 or above\*. Prepare for your future engineering career in a growing tech city – with placement opportunities on your doorstep.

### WHAT WILL I STUDY?

You'll study all of these core modules:

- English Language and Study Skills (20 credits)
- Engineering Mathematics 1 (10 credits)
- Engineering Mathematics 2 (10 credits)

### SPECIALIST MODULES

The table below provides information about the modules you'll need to study based on the degree option chosen. You'll study four modules per Semester and will need to earn 120 credits from all module options to successfully complete Year 1 of your study plan and continue to Year 2 of your degree at Queen's University Belfast. All the specialist modules listed below will be taught by academic experts in these subject areas.

	DEGREE					
	Aerospace Engineering BEng (Hons) <sup>Ⓟ</sup>	Chemical Engineering BEng (Hons) <sup>Ⓟ</sup>	Civil Engineering BEng (Hons) <sup>Ⓟ</sup>	Computer Science BSc (Hons) <sup>Ⓟ</sup>	Electrical and Electronic Engineering BEng (Hons) <sup>Ⓟ</sup>	Mechanical Engineering BEng (Hons) <sup>Ⓟ</sup>
<b>SPECIALIST MODULES (80 CREDITS – ALL MODULES ARE 10 CREDITS)</b>						
Aerospace Principles	•					
Basic Chemistry 1		•				
Basic Chemistry 2		•				
Computer Architecture				•		
Communications					•	
Circuit Principles 1				•	•	
Circuit Principles 2				•	•	
Civil Engineering Principles			•			
Databases				•		
Drawing and Design	•	•	•			•
Digital Systems Design				•	•	
Dynamics	•					•
Electrical and Electronic Engineering						•
Electronic Materials and Devices					•	
Electrical Power and Machines					•	
Engineering Design and Practise				•	•	
Fluid Mechanics	•	•	•			•
Geotechnics			•			
Heat and Mass Transfer		•				
Introduction to Chemical Engineering		•				
Materials and Manufacture	•	•	•			•
Mechanical Principles	•		•			•
Object Oriented Programming				•		
Procedural Programming				•	•	
Structural and Stress Analysis	•		•			•
Surveying			•			
Thermodynamics	•	•				•

<sup>Ⓟ</sup> Degree option with a work placement also available

\* Based on Queen's University Belfast International Study Centre students who graduated 2021–22

\*\* Compared with average Russell Group fees (Reddin Survey 2021). Based on completion of BEng (Hons) Engineering with International Year One or International Year One plus 3 years of degree study, and securing centre and progression scholarships of £8,500.



16 years and above



Year 1 of study plan  
3-term: Sep or Jan



3-term: IELTS 5.5  
(with a minimum of 5.5 in each subskill)  
or equivalent.

Please note that in addition to the UKVI IELTS, we can accept other English language qualifications. For more information on accepted qualifications please see: [intostudy.com/self-alternatives](https://intostudy.com/self-alternatives)



Age requirement



Start dates



English requirements

# PRE-MASTER'S

Don't meet the English requirements? Choose from a standalone Academic English course or combine English with an academic study plan to improve your IELTS score fast.

Improve your subject knowledge and English language skills to the level you need to study a postgraduate degree at Queen's University Belfast.

## FINANCE – PMPF

Choose from  
6 degrees.

Get ready to study at Queen's Business School – ranked 5th in the UK for Accounting and Finance\*. Study real-world case studies from the international business environment and learn through interactive field trips to local industry.

### WHAT WILL I STUDY?

You'll study all of these core modules:

- Accounting for Financial Management (20 credits)
- English Language Study Skills (40 credits)
- Financial and Economic Strategy (20 credits)
- Financial Econometrics (20 credits)
- Financial Market Theory and Investment Analysis (20 credits)

You'll need to earn 120 credits from all module options.

## MANAGEMENT – PMPM

Choose from  
10 degrees.

Progress to a career-led degree including international business, management or marketing. Analyse and interpret practices of global business such as Apple and Google in preparation for your degree.

### WHAT WILL I STUDY?

You'll study all of these core modules:

- Business in an International Context (20 credits)
- Business Management – Environment, Theory and Practice (20 credits)
- Empirical Enquiry and Critical Thought (20 credits)
- English Language Study Skills (40 credits)
- Exploring Culture (20 credits)

You'll need to earn 120 credits from all module options.

## SOCIAL SCIENCES – PMPSS

Choose from  
23 degrees.

This programme leads to a range of degrees in subjects such as psychology, education and law – which is ranked 11th in the UK\*. Gain access to the latest developments in your subject by attending guest lectures at the university.

### WHAT WILL I STUDY?

You'll study all of these core modules:

- Empirical Enquiry and Critical Thought (20 credits)
- English Language Study Skills (40 credits)
- Exploring Culture (20 credits)
- Foundations of Social Science (20 credits)
- Research Design (20 credits)

You'll need to earn 120 credits from all module options.



18 years and above



3-term: Sep or Jan  
4-term: Jun or Sep



3-term: IELTS 5.5  
(with a minimum of 5.5 in all subskills) or equivalent.

4-term: IELTS 5.0  
(with a minimum of 5.0 in all subskills) or equivalent.

Please note that for 3-term programmes, in addition to the UKVI IELTS, we can accept other English language qualifications. For more information on accepted qualifications, please see: [intostudy.com/self-alternatives](https://intostudy.com/self-alternatives)



2-term: Mar  
3-term: Sep or Jan  
4-term: Jun or Sep



2-term: IELTS 6.0  
(with a minimum of 5.5 in all subskills) or equivalent.

3-term: IELTS 5.5  
(with a minimum of 5.5 in all subskills) or equivalent.

4-term: IELTS 5.0  
(with a minimum of 5.0 in all subskills) or equivalent.

Please note that for 2 and 3-term programmes, in addition to the UKVI IELTS, we can accept other English language qualifications. For more information on accepted qualifications, please see: [intostudy.com/self-alternatives](https://intostudy.com/self-alternatives)



2-term: Mar  
3-term: Sep or Jan  
4-term: Jun or Sep



2-term: IELTS 6.0  
(with a minimum of 5.5 in all subskills) or equivalent.

3-term: IELTS 5.5  
(with a minimum of 5.5 in all subskills) or equivalent.

4-term: IELTS 5.0  
(with a minimum of 5.0 in all subskills) or equivalent.

Please note that for 2 and 3-term programmes, in addition to the UKVI IELTS, we can accept other English language qualifications. For more information on accepted qualifications, please see: [intostudy.com/self-alternatives](https://intostudy.com/self-alternatives)



Age requirement



Start dates



English requirements



To find out more,  
scan the QR code

\* The Complete University Guide 2025



PRE-MASTER'S

Once you've successfully completed your Pre-Master's programme, we'll help choose your Queen's University Belfast degree. Depending on your pathway, you could study one of 35+ degrees, including:

DEGREE	PATHWAY(S)	SPECIFIC REQUIREMENTS	ENGLISH LEVEL
Accounting and Finance MSc	PMPF	60% overall in academic modules, with no module score less than 50%	Grade B with a minimum of Grade D in each component
Applied Developmental Psychology MSc*	PMPSS	60% overall in academic modules, with no module score less than 50%	Grade B with a minimum of Grade D in each component
Arts Management MA	PMPM or PMPSS	60% overall in academic modules, with no module score less than 50%	Grade A with a minimum of Grade B in each component
Autism Spectrum Disorders MSc	PMPM or PMPSS	60% overall in academic modules, with no module score less than 50%	Grade B with a minimum of Grade D in each component
Business Analytics MSc	PMPF	60% overall in academic modules, with no module score less than 50%	Grade B with a minimum of Grade D in each component
Children's Rights MSc	PMPM or PMPSS	60% overall in academic modules, with no module score less than 50%	Grade B with a minimum of Grade D in each component
City Planning and Design MSc*	PMPM	60% overall in academic modules, with no module score less than 50%	Grade B with a minimum of Grade D in each component
Clinical Health Psychology MSc*	PMPSS	60% overall in academic modules, with no module score less than 50%	Grade B with a minimum of Grade D in each component
Conflict Transformation and Social Justice MA	PMPSS	60% overall in academic modules, with no module score less than 50%	Grade B with a minimum of Grade D in each component
Construction and Project Management MSc 	PMPM or PMPF	60% overall in academic modules, with no module score less than 50%	Grade B with a minimum of Grade D in each component
Criminology and Criminal Justice LLM	PMPM or PMPSS	60% overall in academic modules, with no module score less than 50%	Grade B with a minimum of Grade D in each component
Criminology and Criminal Justice LLM	PMPM or PMPSS	60% overall in academic modules, with no module score less than 50%	Grade B with a minimum of Grade D in each component
Economics MSc	PMPF	60% overall in academic modules, with no module score less than 50%	Grade B with a minimum of Grade D in each component
Educational Leadership MSc	PMPM or PMPSS	60% overall in academic modules, with no module score less than 50%	Grade B with a minimum of Grade D in each component
Educational Studies Med	PMPSS	60% overall in academic modules, with no module score less than 50%	Grade B with a minimum of Grade D in each component
Film MA	PMPSS	60% overall in academic modules, with no module score less than 50%	Grade B with a minimum of Grade D in each component
Finance MSc	PMPF	60% overall in academic modules, with no module score less than 50%	Grade B with a minimum of Grade D in each component
Geopolitics MA*	PMPSS	60% overall in academic modules, with no module score less than 50%	Grade B with a minimum of Grade D in each component
Global Health MPHGH**	PMPSS	60% overall in academic modules, with no module score less than 50%	Grade B with a minimum of Grade C in each component
History MA	PMPSS	60% overall in academic modules, with no module score less than 50%	Grade B with a minimum of Grade D in each component
Human Resource Management MSc	PMPM	60% overall in academic modules, with no module score less than 50%	Grade B with a minimum of Grade D in each component
Human Rights Law LLM	PMPM or PMPSS	60% overall in academic modules, with no module score less than 50%	Grade B with a minimum of Grade D in each component
Inclusion and Special Educational Needs Med	PMPM or PMPSS	60% overall in academic modules, with no module score less than 50%	Grade B with a minimum of Grade D in each component
International Business MSc	PMPM or PMPSS	60% overall in academic modules, with no module score less than 50%	Grade B with a minimum of Grade D in each component
International Commercial and Business Law LLM	PMPM or PMPSS	60% overall in academic modules, with no module score less than 50%	Grade B with a minimum of Grade D in each component
International Relations MA	PMPSS	60% overall in academic modules, with no module score less than 50%	Grade B with a minimum of Grade D in each component
Interpreting MA	PMPSS	60% overall in academic modules, with no module score less than 50%	Grade B with a minimum of Grade D in each component
Law LLM	PMPSS	60% overall in academic modules, with no module score less than 50%	Grade B with a minimum of Grade D in each component
Leadership for Sustainable Development MSc	PMPM or PMPSS	60% overall in academic modules, with no module score less than 50%	Grade C with a minimum of Grade D in each component
Leadership for Sustainable Rural Development MSc	PMPM or PMPSS	60% overall in academic modules, with no module score less than 50%	Grade C with a minimum of Grade D in each component
Management MSc	PMPM	60% overall in academic modules, with no module score less than 50%	Grade B with a minimum of Grade D in each component
Marketing MSc	PMPM	60% overall in academic modules, with no module score less than 50%	Grade B with a minimum of Grade D in each component
Master of Business Administration MBA	PMPM or PMPF	60% overall in academic modules, with no module score less than 50% Plus: Applicants will normally have a minimum of 5 years' full-time, post-graduation employment experience, preferably in a management capacity. Applicants must provide a full and up-to-date CV together with a detailed personal statement as part of the application process. Eligible applicants will also be interviewed.	Grade B with a minimum of Grade D in each component
Masters in Law Mlaw	PMPSS	60% overall in academic modules, with no module score less than 50%	Grade B with a minimum of Grade D in each component
Media and Broadcast Production MA*	PMPSS	60% overall in academic modules, with no module score less than 50%	Grade B with a minimum of Grade D in each component
Planning and Development MSc	PMPM or PMPSS	60% overall in academic modules, with no module score less than 50%	Grade B with a minimum of Grade D in each component
Politics MA	PMPSS	60% overall in academic modules, with no module score less than 50%	Grade B with a minimum of Grade D in each component
Psychological Science MSc	PMPM	60% overall in academic modules, with no module score less than 50%	Grade B with a minimum of Grade D in each component
Public Health MPH**	PMPSS	60% overall in academic modules, with no module score less than 50%	Grade B with a minimum of Grade C in each component
Risk and Investment Management MSc	PMPF	60% overall in academic modules, with no module score less than 50%	Grade B with a minimum of Grade D in each component
Software Development MSc	PMPM or PMPSS	60% overall in academic modules, with no module score less than 50% Completion of an undergraduate degree in any discipline excluding Computer Science or other similar computing degree. All applicants will also be required to pass an online aptitude test.	Grade C with a minimum of Grade D in each component
Teaching English to Speakers of Other Languages and Applied Linguistics MSc	PMPSS	60% overall in academic modules, with no module score less than 50% TESOL applicants also require evidence of relevant teaching experience (minimum of 30 hours).	Grade B with a minimum of Grade D in each component
Translation MA	PMPSS	60% overall in academic modules, with no module score less than 50%	Grade B with a minimum of Grade D in each component
Violence, Terrorism and Security MA	PMPSS	60% overall in academic modules, with no module score less than 50%	Grade B with a minimum of Grade D in each component
Youth Justice MSc	PMPSS	60% overall in academic modules, with no module score less than 50%	Grade B with a minimum of Grade D in each component

 Degree option with a work placement also available

Please note: English level and academic progression requirements are correct to the best of our knowledge at the time of going to print. In some circumstances these may change throughout the year – please visit our website for the most up-to-date information.

\* Programmes that require relevant undergraduate study  
\*\*Application to this programme must be pre-approved by the university

To find out more,  
scan the QR code



GET READY TO STUDY

Prepare for your UK study abroad experience before you arrive.

Access a mix of interactive activities and videos anywhere, anytime and at no extra cost.

By the time you join us at the centre, you'll feel more confident about:

- STUDENT LIFE IN THE UK
- STUDY SKILLS
- EMPLOYABILITY



93%  
of students felt more prepared  
for their studies

Students completing Get Ready to Study  
(UK Arrival Survey 2023)

THIS PROGRAMME  
HELPED ME TO  
UNDERSTAND WHAT  
IS REQUIRED FOR  
STUDYING IN THE UK.

Maho, Japan



Confirm early to access this free online programme.

Find out more:  
[intostudy.com/get-ready-to-study](https://intostudy.com/get-ready-to-study)

GET WORK READY

Develop your employability skills and prepare for your future career while you study your pathway. You'll:

- develop workplace skills
- set your career goals
- build your brand and professional network
- perfect your CV and interview skills
- prepare for a placement\*.

\* Optional, for students undertaking a UK-based internship or placement.

Find out more:  
[intostudy.com/  
get-work-ready](https://intostudy.com/get-work-ready)



PREPARE FOR YOUR  
STUDIES AND CAREER



# DATES AND PRICES

The cost of your programme may vary depending on factors including the pathway chosen and programme length. The following guide to costs is based on pricing for the current academic year and provides an indication of the cost of attendance for some of our pathways. For specific cost information, scan the QR code:



Estimated cost of attendance based on prices for current academic year 2024–25						
Study length	Tuition	Accommodation	Books and fees	Airport pick up†	Insurance	Total
Academic programmes*						
International Foundation (2 term)	£13,495	£3,850–£4,680	£320	£42–£60	£236	£17,942–£18,791
International Foundation (3 term)	£18,250–£18,700	£5,950–£7,800	£320	£42–£60	£364	£24,926–£27,244
International Foundation (4 term)	£19,250–£19,950	£9,100–£10,140	£405	£42–£60	£392	£29,189–£30,947
International Foundation (5 term)	£21,675–£22,245	£10,850–£12,090	£495	£42–£60	£473	£33,535–£35,363
International Year One (3 term)	£19,995	£5,950–£7,800	£320	£42–£60	£364	£26,671–£28,539
International Year One (4 term)	£21,495	£9,100–£10,140	£405	£42–£60	£392	£31,434–£32,492
International Year One (5 term)	£22,395	£10,850–£12,090	£495	£42–£60	£473	£34,255–£35,513
Pre Master's (2 term)	£15,495	£4,200–£4,680	£320	£42–£60	£236	£20,293–£20,791
Pre Master's (3 term)	£19,995	£5,950–£7,800	£320	£42–£60	£364	£26,671–£28,539
Pre Master's (4 term)	£21,495	£9,100–£10,140	£405	£42–£60	£392	£31,434–£32,492
English language courses						
Academic English (1 term)**	£4,995	£2,100–£2,340	£100	£42–£60	£123	£7,360–£7,618

Start months and term dates 2025–26			
Academic programmes		Academic English	
March start (5 term)	Mon 31 Mar 2025–Fri 19 Jun 2026	September start (1 term)	Mon 15 Sep 2025–Fri 05 Dec 2025
June start (4 term)	Mon 16 Jun 2025–Fri 19 Jun 2026	January start (1 term)	Mon 05 Jan 2026–Fri 20 Mar 2026
June start (5 term)	Mon 16 Jun 2025–Fri 28 Aug 2026	March start (1 term)	Mon 30 Mar 2026–Fri 05 Jun 2026
September start (3 term)	Mon 15 Sep 2025–Fri 19 Jun 2026	June start (1 term)	Mon 15 Jun 2026–Fri 21 Aug 2026
September start (4 term)	Mon 15 Sep 2025–Fri 28 Aug 2026		
January start (3 term)	Mon 05 Jan 2026–Fri 28 Aug 2026		
March start (2 term)	Thu 30 Mar 2026–Fri 28 Aug 2026		

Please note the prices shown are for the current academic year of 01 September 2024–31 August 2025 and are for indicative purposes only.

\* Prices shown are for our standalone university preparation courses only. Prices for Year 1 of our courses, which combine a pathway with a degree programme under a single CAS, are the same as the standalone prices. Prices for subsequent years are in line with university tuition fees.  
\*\* The price will depend on your start date and length of study. Prices shown are only for one term. Vacation weeks in between terms are extra and will be charged at the weekly accommodation price.  
† Please note airport pick up is optional and is not included in the total.

Apply online:  
apply.intostudy.com

Apply via your local INTO education counsellor.  
If you would like us to put you in contact with one of our counsellors please contact us.

Scholarships available  
Visit our website to check if you're eligible.

## Discover more online

For students:  
qubisc.com  
For education counsellors:  
partnerportal.intoglobal.com/queens



## Contact us

intostudy.com/en/contact  
Arrange a visit:  
isc@qub.ac.uk or +44 28 9097 6850

Queen's University Belfast International Study Centre  
Queen's University Belfast  
2–8 Lennoxvale  
Belfast  
BT9 5BY  
Northern Ireland

© INTO Queen's LLP, September 2024. Every effort is made to ensure that the information provided in this document is correct at the time of publication. However, from time to time there may be occasions where some of the information has changed since the date of publication. The most up to date information can be found on our website at intostudy.com/queens – please refer to this before submitting your application. If, in our opinion, we consider that any change has been made which has a material impact on any offer that has been made to you to study with us we will inform you of these changes in writing. The information provided in this document is subject to INTO Queen's terms and conditions which can be accessed at intostudy.com/queens/terms  
INTO Queen's LLP, registered number NC000503.  
Registered office: 2-8 Lennoxvale, Belfast, Co. Antrim, BT9 5BY, UK.  
Education provider sponsor number 25N2W99V3

IN PARTNERSHIP WITH



Through innovative partnerships with leading universities, we expand opportunities for higher education, ensuring success and transforming the lives of our students and staff.

