

# Your destination for **research** and **innovation**

Guide for international students 2025-2026





# UAB IS YOUR DESTINATION FOR RESEARCH AND INNOVATION

## TOP 7%

Best Global University  
*U.S. News & World Report 2024*

## #76

in Top Public Schools  
*U.S. News & World Report 2024*

## #1

in Cybersecurity  
(Graduate)  
*Fortune 2024*

### FAST FACTS

Founded: <b>1969</b>	International students: <b>1,700+</b>
Campus: <b>Birmingham, Alabama</b>	Countries represented: <b>100+</b>
Metro population: <b>1.2 million</b>	Bachelor's: <b>60</b>
Campus size: <b>Covers 100 city blocks</b>	Master's and PhD: <b>100+</b>
Enrollment: <b>21,160</b>	Research: <b>\$770M+</b>



## #1

in Health  
Administration (MSHA)  
*U.S. News & World Report 2023*

## #7

in Nursing  
(Undergraduate)  
*U.S. News & World Report 2024*

## #13

in Public Health  
(Biostatistics)  
*U.S. News & World Report 2024*

## #16

in Public Health  
(Health Policy and  
Management)  
*U.S. News & World Report 2024*

## #69

in Biomedical  
Engineering  
*U.S. News & World Report 2024*



# World-class careers

## UAB career services

- Career fairs
- Career planning tools
- Handshake (job listing website)
- On-campus interview practice
- Personalized advising

## Alumni spotlight: John | China

MA in TESOL, Class of 2022  
Associate Dean's Office Administrative Assistant  
IPPSE Coordinator at the Center for Urban Education

*"Living in another country while working on personal growth is difficult. You need all the support you can find. I feel so supported at UAB, and I succeeded ...The professors are very understanding and considerate. They love their students and support their students however they can. They are the best mentors I have ever had."*

Originally from China, John leveraged the resources, education and support he received at UAB to launch his career. He received a variety of employment offers, including:

- an international marketing position at an e-commerce company in Saint Petersburg, Russia
- a teaching position at a top high school in Jiangsu, China
- an advising position at an education abroad agency in Shanghai, China
- an administrative position at a manufacturing company in Ohio and Tennessee
- a position in one of the biggest school districts in Alabama

# Innovation and entrepreneurship

UAB is a destination for entrepreneurs.  
Make your ideas a reality with UAB's guidance and resources.

- The Green and Gold Fund manages more than \$600,000 in assets for students to perform actual investment portfolio management with real money.
- The Blazer Hatchery and Hackathon is a student competition and educational experience that attracts local investors to hear students' pitches, with cash prizes for the winners.
- The Bill L. Harbert Institute for Innovation and Entrepreneurship connects scientists and entrepreneurs with industry and investors.
- The UAB iLab at Innovation Depot provides student entrepreneurs with training and resources to accelerate their business ideas and start their own companies.

## Faculty spotlight:

### Patrick J Murphy, PhD

Goodrich Entrepreneurship Chair

Patrick J Murphy, PhD, is the Goodrich Entrepreneurship Chair and head of UAB's award-winning Barefield Entrepreneurship Program. His research is used to train students in universities around the world. In addition, his seminars utilize innovative outreach engagements to transform UAB students into entrepreneurs.

*"The Barefield Entrepreneurship Program has an award-winning and rigorous academic curriculum. We make an impact on the futures of our students and on our community by merging theory and practice in everything we do."*

## Alumni spotlight: Vien | Vietnam

As a former data science student and assistant to Dr. Patrick J Murphy, Vien's time at UAB gave him the tools and experience to quickly launch a successful career after graduation.

- Received three job offers before graduation
- Joined Quantalytix, a Birmingham-based startup
- Promoted to Chief Technology Officer just two years after joining the company

*"Two years at UAB sharpened my reasoning and analytical skills, which enable my immediate contributions to the development of the company. All the hard work and determination really paid off."*

Innovation Depot, co-founded by UAB, is the largest high-tech incubator in the Southeast.

## BIRMINGHAM TECH BOOM

Birmingham is an up-and-coming tech hotspot, with a number of successful startups, including Shipt, a grocery delivery service, and Daxko, a software for health and wellness organizations.

## ONE OF THE "BEST LARGE CITIES TO START A BUSINESS"

WalletHub 2024



# RESEARCH

with global impact

**7,000+** undergraduate students  
and  
**7,600+** graduate students  
involved in research

Dedicated Office of Service Learning and Undergraduate Research that helps place students in research labs as soon as freshman year.

**\$12.1  
BILLION**

economic impact in the state  
of Alabama

## Alumni spotlight: Nabaa | Pakistan

A biology undergraduate originally from Pakistan, Nabaa quickly immersed herself in UAB's community and took part in student leadership and groundbreaking research as a:

- orientation leader and international mentor
- COVID-19 screener at Children's of Alabama Hospital
- researcher with the Cancer Research Immersion Program
- student assistant for Dr. Patrick J Murphy
- participant in the 2023 UAB Global Health Case Competition winning team

Nabaa was accepted into Harvard Medical School for her remarkable achievements and leadership.

*"UAB provided me with not only the knowledge and skills, but also the support and resources needed to excel in my field. The emphasis on research and innovation has truly shaped my journey, enabling me to confidently pursue my professional goals with enthusiasm and a drive for continuous growth."*



## Student spotlight: Tuan Anh | Vietnam

MS in Multidisciplinary Biomedical Science, Class of 2024  
Research Assistant in the Department of Pediatrics – Division of Pediatrics Pulmonary and Sleep Medicine

*"I am most excited about the chance to contribute to research using cutting-edge technology here at UAB. For the next chapter with UAB, I believe the environment here will broaden my horizons and shape me into a well-rounded scientist in the future"*

**Dr. Jianyi "Jay" Zhang**, MD, PhD, FAHA, is an international leader in myocardial biomaterials and stem cells for cardiac repair. He's also a professor of medicine and engineering, chair of the Department of Biomedical Engineering and the Michael and Gillian Goodrich Endowed Chair of Engineering Leadership at UAB.

The late astrophysicist **Dr. Thomas Wdowiak**, PhD, was a professor emeritus of physics at UAB. His work helped get a rover to Mars, and he has an area of the planet named after him called "Wdowiak Ridge."



## World-class faculty

Shadi S Martin, PhD, is UAB's Vice Provost for Graduate and International Education, Dean of Graduate School and Chief International Officer. She was a Fulbright Scholar in Damascus, Syria and has worked with the World Health Organization in Europe and the United Nations High Commissioner for Refugees in the Middle East. Dr. Martin is leading the initiative to further expand international initiatives at UAB and is dedicated to connecting UAB and the rest of the world through international exchange.

*"I believe an international exchange of students and scholars is critical for the greater global good, creating a richer, kinder and more accepting world. Having international students and scholars at UAB is just as important as having our students and scholars travel abroad. We are far more likely to solve complex world problems if we can bring these great minds together."*

**Shadi S Martin, PhD**  
Vice Provost



# BIRMINGHAM is ready for you

Every year, Birmingham gains more recognition as a rising travel and career destination. And it makes sense, with food, art, culture and industry you just won't find anywhere else.

## #2

City Where Your  
Dollar Goes the Furthest  
*Porch 2022*



## Diversity

### One of 15

universities recognized as a diversity champion by  
*INSIGHT Into Diversity Magazine 2023*

### 1,700+

international students and 600+ international  
faculty, staff and visiting scholars, representing over  
100+ countries

**100+** international partnerships with universities,  
hospitals and other organizations



## AFFORDABILITY

Even as an emerging travel destination and tech  
hub, Birmingham is also considered one of the most  
affordable cities in the United States. Enjoy living in a  
vibrant and growing local community without worrying  
about overspending.

At the heart of the Civil Rights movement,  
Birmingham's history is honored throughout  
the city. Visit the Birmingham Civil Rights  
Institute and the Negro Southern League  
Museum to learn about local heroes like Martin  
Luther King Jr, Rosa Parks and other key  
figures in American history.

## Arts

Explore Birmingham's thriving arts and music scene, from film  
festivals and vibrant street art to performances by some of the  
biggest names in music.

## Food

Birmingham is known for great food at great prices. In 2023, two  
Birmingham restaurants were finalists for the prestigious James  
Beard Foundation Awards.

## Parks

Explore Birmingham's parks and massive greenspace, such as the  
Vulcan hiking trail just off UAB's campus or Ruffner Mountain, the US'  
second-largest nature preserve.

## Sports

Baseball, soccer, hockey, golf – Birmingham has it all. Check out  
Birmingham's sports scene, from the major league to minor league.  
Be sure to catch one of UAB's highly-ranked teams playing nearby.



# Cutting-edge programs

**97%** of UAB's computer science undergraduates have a job within six months of graduation.



**OVER \$770M**  
in research funding  
in 2023

## Computer Science and Cybersecurity

[www.uab.edu/cas/computerscience](http://www.uab.edu/cas/computerscience)

- Gain hands-on experience participating in cutting-edge research funded by government organizations and leading tech companies.
- Graduates of UAB computer science programs include successful entrepreneurs and technology leaders at Facebook, Google, Microsoft, national labs and more.
- UAB's master's in cybersecurity was ranked **No. 1** in the US by *Fortune* 2024.

## Electrical and Computer Engineering

[www.uab.edu/engineering/ece](http://www.uab.edu/engineering/ece)

- Develop the foundational skills for electrical and computer engineering careers. Our program covers advanced analog and digital electronics, biomedical instrumentation, digital computer systems, industrial electronics and beyond.
- Gain hands-on experience through internships and participating in research projects alongside UAB's world-renowned faculty.
- Undergraduate engineering students are guaranteed an internship during their time at UAB.



### Faculty spotlight:

#### YULIANG ZHENG, PHD

UAB Computer Science Chair

Known as the father of signcryption technology, an international standard for cybersecurity, Dr. Zheng oversees UAB's rapidly growing computer science program.

*"Our faculty are top-notch educators and leaders in their fields."*

## The Collat School of Business

at UAB is accredited at the bachelor's and master's levels by the Association to Advance Collegiate Schools of Business International (AACSB), representing the highest standard of achievement for business schools worldwide.

## Best College for Business in Alabama

*Niche 2023*

## Business

[www.uab.edu/business](http://www.uab.edu/business)

- Earn your degree in an innovative, customizable business program. Our program will give you the skills and experience needed to succeed in today's complex business world.
- Choose from a variety of customizable undergraduate majors and graduate concentrations in entrepreneurship, marketing, finance, business analytics and more.

The South and East Science halls of UAB's Science and Engineering Complex were completed in August 2023. This state-of-the-art facility includes:

- modern classrooms
- cutting-edge research labs
- collaborative spaces
- dedicated faculty and staff offices

## Biotechnology

[www.uab.edu/shp/cds/biotechnology](http://www.uab.edu/shp/cds/biotechnology)

- Biotechnology is a versatile field. It applies to careers in business, research, healthcare and more.
- Graduate prepared to bring major new health innovations to life.

## YOUR HEALTHCARE CAREER BEGINS AT UAB

As a thriving entrepreneurial and tech center with a strong healthcare economy, Birmingham is the perfect place to start your career.

Discover healthcare jobs and internships via UAB affiliates like Southern Research, a pioneering Southeastern science center renowned for developing seven FDA-approved anticancer drugs and numerous chemotherapy breakthroughs.

## Nursing

[www.uab.edu/nursing](http://www.uab.edu/nursing)

- Train in a nursing school ranked **No. 7** in the nation for a bachelor's and **No. 11** for a doctoral degree by *U.S. News & World Report* 2024.
- Nurse practitioner was ranked the **No. 1** healthcare job and the **No. 1** best job in the US by *U.S. News & World Report* 2024.

The median annual wage for nurse anesthetists, nurse midwives and nurse practitioners is

**\$129,480**

*U.S. Bureau of Labor Statistics 2023*

## Multidisciplinary Biomedical Science

[www.uab.edu/graduate/programs/msbms](http://www.uab.edu/graduate/programs/msbms)

- Our multidisciplinary biomedical science program applies to a wide range of careers in the medical field. Your program will include research science, scientific policy, science communication, biomedical sales and more.
- Take part in cutting-edge research at Alabama's premier institution for biomedical research.

The Science and Engineering Complex is slated for completion by mid-2025, promising even more exciting advancements for UAB's science and engineering programs.

## Public Health

[www.uab.edu/soph](http://www.uab.edu/soph)

- Address the problems facing today's public health experts. Make an impact on your local and global community.
- Our public health graduate program was ranked **No. 18 (tie)** in the nation by *U.S. News & World Report* 2024.
- UAB, an early academic medical center for in-house COVID-19 testing, played a vital role in administering the vaccine throughout Alabama and developed Remdesivir for COVID-19 treatment.



Academic programs

**Find your degree.** With a wide range of subject areas and admissions options, you can find the perfect degree for your chosen career. You can choose to apply for direct entry to the university or for a Pathway program that provides extra academic, language and cultural support. From the day you apply to the day you graduate, we are here to help you succeed every step of the way. Flip to the back cover to learn how to apply.

B = Bachelor's

M = Master's

D = Doctorate

International Year One may lead to any bachelor's degree listed below.

GP

Graduate Pathway program that can lead to this degree is indicated in blue. This UAB degree is available through direct entry or International Direct.

IMP

Integrated Master's Program provides customized support to direct entry students.

This UAB degree program is available through direct entry.

Designated STEM degree by the U.S. Department of Homeland Security. It may vary by degree level.

Stipulations apply for admission to this bachelor's program; please visit department website for more information.

	B	M	D
College of Arts and Sciences			
African-American Studies [BA concentrations in Minority and Global Public Health and Social Justice, Historical Investigation and Cultural Awareness, History and Culture of Afro-Caribbean and Latino People]	GE		
Anthropology [MA concentration in Peace and Human Rights]	GE	●	
► Applied Mathematics			●
Art [BFA concentration in Art Studio] [BA concentrations in Art Studio and Art History]	GE		
Art History		●	
► Biology [BS concentrations in Integrative Biology, Marine Science and Molecular Biology]	SC	●	●
► Chemistry [BS concentrations in Biochemistry, Chemical Education, Forensic Chemistry, Polymer Chemistry]	SC	●	●
Communication Management		●	
Communication Studies [BA concentrations in Communication Management, Mass Communication (Journalism, Broadcasting, Public Relations), Sports Communication]	GE		
► Cyber Security [MS concentrations in Cybercrime Investigations, IT Audit/Fraud Examinations]		GP IMP	
► Computer Science [BA and BS in Computer Science]	CS	GP IMP	●
Criminal Justice	GE	●	
Cultural Heritage Studies [MA concentrations in Cultural Administration, Cultural Heritage]		●	
► Data Science		GP IMP	
Digital Forensics	GE		
English [BA concentrations in Creative Writing, Linguistics, Literature, Professional Writing]	GE	●	
► Forensic Science		●	
General Studies	GE		
Genetics and Genomic Sciences	SC		
History	GE	●	
Pre-Cancer Biology*	SC		
Pre-Immunology*	SC		
International Studies	GE		
► Mathematics Four tracks leading to a BS in Mathematics: Mathematics (traditional), Mathematical Reasoning, Applied Mathematics and Scientific Computation and Mathematics with Honors	SC	●	●

International Year One

Indicates the International Year One program that should be taken to progress to an undergraduate academic program. This degree is also available through direct admission.

BU Business

CS Computer Science

EN Engineering

GE General

PN Pre-Nursing

PH Public Health

SC Science

All bachelor degree programs are available for direct admission or International Direct.

	B	M	D
Medical Sociology	GE		●
Music [BA* concentrations in Music Education Vocal, Music Education Instrumental, Music Technology]	GE		
Musical Theatre [BFA]	GE		
► Natural Science	SC		
► Pre-Neuroscience*	SC		
Philosophy [BA concentration in Ethics]	GE		
► Physics [BS concentrations in Advanced Physics, Applied Physics, Biophysics, Computational Physics] [PhD concentration in Applied Physics]	SC	●	●
Political Science [BA concentrations in American Government and Political Theory; Comparative Politics and International Relations]	GE		
Psychology [PhD concentrations in Behavioral Neuroscience; Developmental Psychology; Medical and Clinical Psychology]	GE		●
Public Administration [Dual-degree programs: MPA/Master of Criminal Justice; MPA/MPH; MPA/JD]		GP IMP	
Social Work [MSW concentration in Clinical/Medical Social Work]	GE	●	
Sociology [BA concentration in Social Psychology]	GE	●	
Theatre [BA concentrations in General Theatre; Pre-Professional Design and Technology; Pre-Professional Performance]	GE		
World Languages and Literatures [BA concentrations in French, Japanese, Spanish, Applied Professional Spanish]	GE		
Writing and Media	●		
Collat School of Business			
Accounting	BU	●	
Business Administration [MBA concentrations in Business Analytics, Finance, Entrepreneurship, Health Services, Management Information Systems, Marketing] [Dual-degree program: MBA/MPH]		GP IMP	
Economics [BS concentrations in Economic Analysis and Policy; Mathematical Economics; Philosophy, Politics and Economics]	BU		
Entrepreneurship	BU		
Finance [BS concentrations in Financial Management; Investments and Institutions; Real Estate]	BU		
Human Resource Management	BU		
Information Systems [BS concentrations in Cybersecurity Management and Data Analytics]	BU		
Industrial Distribution [BS concentration in Medical Equipment and Supplies Distribution]	BU		

	B	M	D
Management [BS concentrations in Business Administration, Production and Operations]	BU		
Marketing [BS concentrations in Marketing Management, Digital Marketing, Retail Marketing Management, Marketing Analytics]	BU		
School of Education and Human Sciences			
Arts Education [MAEd concentration in Music and Virtual Arts]		●	
Community Health and Human Services [BS concentrations in Community Health, Human Services]	GE		
Community Health [MAEd concentrations in Online Community Health, Community Health with Nonprofit Management]		●	
Counseling [MA concentrations in Clinical Mental Health; Marriage, Couples and Family Counseling; School Counseling]		●	
Early Childhood and Elementary Education	GE	●	●
Educational Studies [MAEd concentrations in Early Childhood Education, Elementary Education, Secondary Education, Special Education, Physical Education]		GP IMP	
Educational Studies in Diverse Populations [PhD concentrations in Health Disparities in Diverse Populations; Pedagogical Studies; Context, Culture and Policy]			●
English as a Second Language [MAEd concentrations in Alternative MAEd/ESL, P-12 cert. (ESL, ESL/ French, ESL/Spanish); Traditional MAEd/ESL, P-12 cert. (ESL, ESL/French, ESL/Spanish); TESOL, non-certification (for teaching adult learners)]		GP IMP	
Kinesiology [BS concentrations in Exercise Bioenergetics, Exercise Science, Sports Physiology and Performance, Physical Education with Teacher Certification] [MS concentrations in Physical Education with Teacher Certification (Traditional and Alternative), Exercise Physiology]	GE	●	
Reading Education		●	
Special Education (Collaborative Teacher) [MAEd concentration in Early Childhood Special Education, Collaborative Teacher K-6 and 6-13]		●	
Secondary Education [BS concentrations in English Language Arts, General Social Science] [MAEd concentration in Biology, Chemistry, English, French, English Language Arts, General Science, General Social Science, History, Mathematics, Physics]	GE	●	
School of Engineering			
► Biomedical Engineering [BSBME* concentrations in Biomaterials , Tissue Engineering and Biomechanics]	EN	●	●
► Civil Engineering [BSC* concentrations in Sustainable Engineering Design and Construction]	EN	GP IMP	●
► Computer Engineering			●
► Electrical and Computer Engineering	EN	GP IMP	
► Engineering Design	EN		
► Engineering Management		GP IMP	
► Interdisciplinary Engineering			●
► Materials Engineering [BSMTE* concentrations in Biomaterials, Metallurgy, Polymer Matrix Composites]	EN	GP IMP	●
► Mechanical Engineering*	EN	GP IMP	
Neuroengineering			●
School of Health Professions			
Administration/Health Services [PhD concentrations in Strategic Management, Health Services Research, Health Informatics]			●
► Biobehavioral Nutrition and Wellness	SC		
► Biomedical and Health Sciences		●	
► Biomedical Sciences [PhD concentrations in Biochemistry and Structural Biology; Cancer Biology; Cell, Molecular and Developmental Biology; Genetics, Genomics and Bioinformatics; Immunology; Microbiology; Neuroscience; Pathobiology, Pharmacology and Physiology]	SC		●
► Biotechnology		GP IMP	

	B	M	D
Genetic Counseling		●	
Genetics, Genomics, and Bioinformatics			●
Genetics and Genomic Sciences	SC		
Health Administration [MSHA concentrations in Health Administration - Residential, Health Administration - Executive]		●	
Healthcare Simulation		●	
► Health Physics		●	
Healthcare Management [BS concentrations in Clinical Manager, General Manager, Pre-Professional, Long-term Administration]	GE		
► Healthcare Quality and Safety		●	
► Medical Laboratory Science		●	
Nuclear Medicine and Molecular Imaging Sciences [MS tracks in Imaging Specialist, Radiation Safety, Research]		●	
► Nutrition Sciences [MS tracks in Dietetic Internship/Clinical; Research; Lifestyle Management and Disease Prevention; Dietitian Education, Clinical Track - Prior Learning]		●	●
Occupational Therapy [OTD concentrations in Entry-Level Track; General Track; Low Vision Rehabilitation Track; Healthcare Quality and Safety Track]		●	●
Physical Therapy			●
Rehabilitation Science			●
Joint Health Sciences			
► Anatomical Science		●	
► Microbiology			●
► Multidisciplinary Biomedical Science [MS concentrations in Genetics and Genomics Sciences; Cancer Biology; Bioinformatics; Immunology; Neuroscience, Pharmacology and Toxicology]		GP IMP	
School of Nursing			
Nursing [BSN*, DNP, PhD]	PN		●
School of Public Health			
Bioinformatics	SC	●	
► Biostatistics		●	●
► Environmental Health Science			●
► Epidemiology			●
Health Behavior			●
Public Health [BS concentrations in Environmental Health Sciences, Public Health, Global Health Studies] [MPH concentrations in Health Policy and Organization; Health Behavior; Epidemiology; Environmental and Occupational Health; Population Health; Maternal and Child Health Policy and Leadership]	PH	GP IMP	●
School of Optometry			
Vision Science		●	●



To learn more about our programs, please scan the QR code or visit [www.intostudy.com/en/universities/the-university-of-alabama-at-birmingham/programs](http://www.intostudy.com/en/universities/the-university-of-alabama-at-birmingham/programs)

For our complete program catalog, please visit [www.uab.edu/degrees](http://www.uab.edu/degrees)



# Your destination for future careers

## EMPLOYERS OF UAB GRADUATES:

- Apple
  - AT&T
  - BBVA Compass
  - Boeing
  - Coca-Cola
- Ernst & Young
  - Ford Motor
  - Goldman Sachs & Co.
  - Google
  - Honda
- IBM
  - Intel
  - Justice Department
  - LinkedIn
  - Microsoft
- UAB
  - United Health Group
  - Visa
  - Wells Fargo & Co.
  - Xerox Corporation



### Alumni spotlight: Shegun

Since graduating from UAB in 2003, Shegun has founded multiple highly successful companies, including Therapy Brands, which sold for over a billion dollars in 2021. To give back, Shegun and his wife, Mary, a fellow UAB alumnus, created the Shegun and Mary Otulana Endowed Scholarship. Each year, the scholarship provides tuition for an international student and a student from an underrepresented background.

*“We hope [the scholarship] translates into them doing really great things in the future and continuing the journey and coming back and impacting other people’s lives, writing a positive story about what it means to have African ancestry. This is not just about you being able to pay your tuition. It’s about you being able to have an impact in life, whatever way that is.”*

Shegun | Nigeria

Class of 2003

Founder of Zertis, Therapy Brands and Harmony Venture Labs



## Estimated cost of attendance



Please scan the QR code for the most up-to-date tuition and scholarship information.

## Housing *and* dining

### On-campus housing

Program	REQUIRED*	NOT REQUIRED
Academic English (AE)		■
AE + International Year One (IYO)*	■	
IYO*	■	
AE + Undergraduate Transfer Program (UTP)		■
UTP		■
Undergraduate direct*	■	
AE + Graduate Pathway (GPW)		■
International Direct*	■	
GPW		■
Integrated Master's Program (IMP)		■
Graduate direct**		N/A

\*On-campus housing is required for the first two semesters.

\*\*On-campus housing is not available for graduate direct students.

### Meal plan:

Both the undergraduate and graduate housing options include a corresponding meal plan. Meal plans are also available to students who live off-campus.

### 15+ on-campus dining locations

### Student life

- 400+ student clubs and organizations focusing on leadership, cultures, civic engagement, fraternities and sororities, faith, media and more
- 20+ club sports including lacrosse, soccer, cricket and rugby
- 18 Division I sports teams

### Safety and security

Your safety is our top priority. UAB is dedicated to ensuring a safe and secure environment for all students, faculty, staff, patients and visitors by implementing various security measures to protect the campus community with:

- electronic access control systems installed on UAB buildings and facilities
- residence halls with staff at the front desk 24 hours per day and required guest check-in at entry
- a dedicated and well-trained UAB Police Department that has police officers patrolling the campus 24 hours per day
- 490+ Help Phones across UAB’s campus to provide a direct link to the UAB Police and Public Safety Department 24 hours per day
- B-Alert, the university’s emergency notification system, to share important and direct updates to the campus community
- free and confidential counseling services for all actively enrolled UAB students through UAB Student Counseling
- late-night, on-demand transportation services for UAB students and employees through UAB Blazer Express Safety Escort
- the Rave Guardian app to help you build your private safety network and connect you with UAB Police and other emergency services
- monitored video surveillance throughout campus to enhance campus safety and security



### Campus connections

Incoming international students can join the **UAB International Mentors Program**, pairing you with a current university student. Your mentor will assist you in adapting to life at UAB and the US, connecting you with resources and organizing enriching events to enhance your student journey.

You will also be added to the **INTO UAB Community**, an exclusive online platform and resource that connects you with students and staff for personalized advice on housing, student employment, student life, events, academic success and more.



#### Undergraduate on-campus housing:

Suite-style, double-occupancy room with a shared bathroom and common areas.

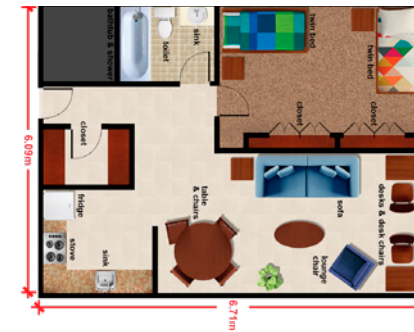

#### Graduate on-campus housing:

Double-occupancy apartment with a shared bathroom and common areas.



## INTO The University of Alabama at Birmingham

Mervyn H. Sterne Library, Floor 2  
917 13th Street South  
Birmingham, AL 35294  
USA

T: +1 205 934 4686  
F: +1 205 934 4685  
E: [UABAdmissions@intoglobal.com](mailto:UABAdmissions@intoglobal.com)

[www.intostudy.com/uab](http://www.intostudy.com/uab)

### Find us on:

 [facebook.com/INTOBlazers](https://facebook.com/INTOBlazers)

 [instagram.com/into\\_UAB](https://instagram.com/into_UAB)

 [x.com/INTO\\_UAB](https://x.com/INTO_UAB)

 [myin.to/uabyoutube](https://myin.to/uabyoutube)

 [myin.to/linkedin\\_uab](https://myin.to/linkedin_uab)

 [tiktok.com/@into\\_uab](https://tiktok.com/@into_uab)

 **WeChat**



### INTO Community app



# HOW TO APPLY

Choose from two easy ways to apply

1

Apply via your local  
INTO educational counselor

2

Apply online  
Complete our online application  
form:

INTO UAB programs:  
[www.intostudy.com/apply-uab](http://www.intostudy.com/apply-uab)

Direct undergraduate:  
[uab.apply.intoglobal.com/login](http://uab.apply.intoglobal.com/login)

Direct graduate:  
For graduate programs in  
biotechnology, business administration,  
data science, cyber security, computer  
science, engineering management,  
mechanical/materials/civil/electrical  
and computer engineering,  
multidisciplinary biomedical science,  
public administration, educational  
studies and public health:  
[uab.apply.intoglobal.com/login](http://uab.apply.intoglobal.com/login)

All other graduate programs:  
[uab.edu/graduate/students](http://uab.edu/graduate/students)

# INTO

Through innovative partnerships with leading universities, we  
expand opportunities for higher education, ensuring success and  
transforming the lives of our students and staff.

Connect with us



## Discover more online

For counselors:



For students:



Education counselor's stamp